



Libra BS



HANGERS





SYMBOLS AND FINISHES LEGEND

SYMBOLS

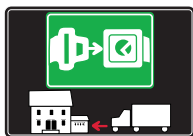

= SHELF SAFELY LOCKED DURING
TRANSPORTATION AND AT HOME.



= ANTI-TURNOVER LOCKING SYSTEM



= NORMS / PATENTS



= PHILLIPS / POZIDRIV



= WITH BUFFER



= PART NO.



= BLADE SLOT



= WITH MAGNET



= PCS. PER PACKAGE



= COMBI SLOT



= HEXAGONAL SOCKET



= NEWTON



= CAPACITY LOADING



= HEXALOBULAR SOCKET



= FRICTION



= WOOD / GLASS
THICKNESS



= COUNTERSUNK HEAD



= AUTOMATIC



= HOLE DIAMETER



= PAN HEAD



= DROP DOWN



= DIAMETER



= FLANGE HEAD



= LENGTH



= FLAT HEAD



= STANDARD HINGE



= HEIGHT



= TRILOBULAR SCREW



= KIMANA HINGE



= RIGHT VERSION



= SELF-TAPPING SCREW



= FLAP HINGE



= LEFT VERSION



= EURO THREAD



= WITH SPRING



= SETTING CODE



= METRIC THREAD



= WITHOUT SPRING



= PCS. PER PAD



= PRE-INSERTED SCREW



= REVERSED SPRING



= CUT ON REQUEST



= PRE-INSERTED SCREW
AND SPREADING BUSH



= SELF ADHESIVE



= WITH FLANGE

NOTE: Printing errors and omissions may exist despite our best efforts to ensure accuracy. We reserve the right to alter specifications without notice.

MATERIALS

ZA = Zinc Alloy	ST = Steel	HSS = High Speed Steel	BR = Brass	ABS = Acrylonitrile Butadiene Styrene
ZAnk = Nickel-plated Zinc Alloy	STzk = Zinc-plated Steel	AL = Aluminium	WD = Wood	EVA = Ethylene Vinyl Acetate

EP = ENGINEERING PLASTIC	+ EP = other engineering plastic available on request	SR = SOFT RUBBER	+ SR = other soft rubber available on request
--	--	--------------------------------	--

EPn = Natural Engineering Plastic	EPc = Clear Engineering Plastic	SRn = Natural Soft Rubber
EPw = White Engineering Plastic	EPg = Grey Engineering Plastic	SRw = White Soft Rubber
EPwg = Water Green Engineering Plastic	EPa = Anthracite Engineering Plastic	SRb = Black Soft Rubber

 FINISHES	+  = OTHER FINISHES AVAILABLE ON REQUEST
--	---

PART NO.	FINISHES	PART NO.	FINISHES	PART NO.	FINISHES
OO	Insignificant finish	IF	Middle Grey	RO	Red
AA	Natural	IJ	Light Grey	UT	T-Met 9007
AB	White	IL	Grey 20	UZ	T-Met
AE	White 9010	IN	Grey met. 26	WA	Bronzed
EA	Black	JB	Bright Aluminium	WI	Burnished
EC	Matt Black	JC	Aluminium - Chrome	XD	Satin-finished Steel
EE	Anthracite	JD	Matt Aluminium	YA	Nickel-plated
EW	Grey 9007	JE	Satin-finished Aluminium	YB	Bright Nickel-plated
FU	Gunmetal	JF	Aluminium - Brass	YC	Matt Nickel-plated
FV	Gunmetal V52	JG	Aluminium 5	YD	Satin-finished Nickel-plated
GR	Raw	JL	Aluminium PE 11	YQ	Black Nickel
HA	Brass-Plated	JM	Aluminium RAL 9006	Z9	Black Zinc
HH	Tropicalized	KA	Chrome	ZA	Zinc alloy
HL	Raw Brass	KB	Bright Chrome	ZN	Zinc-plated
HX	Graphite	KC	Matt Chrome	ZQ	Bright Gold
IA	Grey	LD	Brown 8019	ZY	Titanium
IB	Metallic Grey	NN	Metallic Beige	ZZ	Clear

LIBRA BS APPLICATIONS

BENEFITS OF LIBRA BS HANGING SYSTEM:

- Vertical and in-depth adjustments, with integrated locking of the cabinet, can be easily and smoothly carried out from the inside.
- The hanging system is never interfering with the slides for drawers thanks to the slim side bracket wings.
- Absolutely no mills, nor grooves required on the side panels.

In the **current absence of a unifying European norm** which sets the standards for testing procedures aimed at defining capacity loadings of hanging systems conceived for suspended base units, we Italiana Ferramenta have simulated some of the most critical scenarios. The following simulations are meant to give our customers valid reference points concerning cabinet dimensions, weights, recommended loading capacity even when loaded drawers are opened. **The reported data, empirically obtained, exclusively refer to the constructions and examples shown, correctly positioned and assembled.**

The customer must ensure that the wall is of suitable quality and structure.

Other important factors to be taken into consideration are determined by:

- the type of side panel, the actual thickness and the material used.
- the type and dimensions of the screws used.
- the actual positioning, depth and width of the groove milled for the back side installation.
- the capacity loading of the drawer slides used as well as the actual construction of the drawer.

We always recommend to test a complete cabinet.

For cases which differ from the ones reported, please contact us.

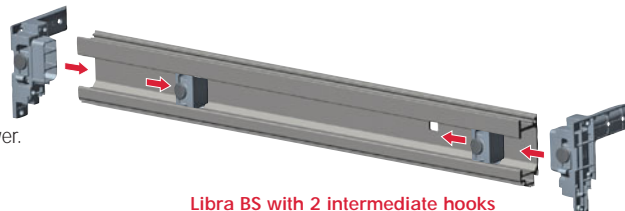
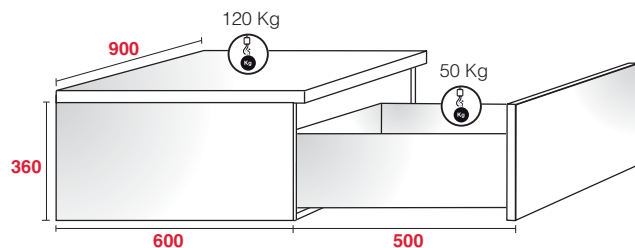

Libra BS with 2 intermediate hooks

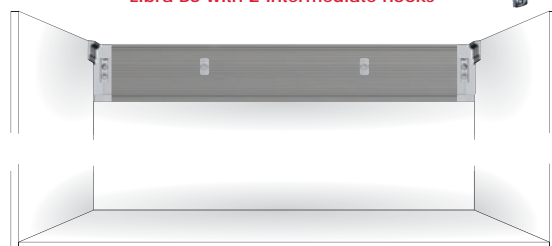

Libra BS with 2 intermediate hooks



Libra BS with 1 intermediate hook



The reported data, empirically obtained, exclusively refer to the constructions and examples shown, correctly positioned and assembled.

The reported data, empirically obtained, exclusively refer to the constructions and examples shown, correctly positioned and assembled.

The reported data, empirically obtained, exclusively refer to the constructions and examples shown, correctly positioned and assembled.



The hanging system is never interfering with the slides for drawers thanks to the slim side bracket wings.

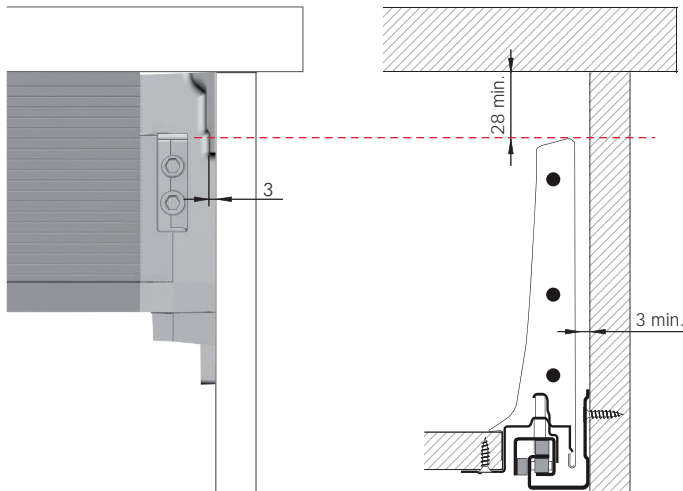

Easy access to the adjustments



The slim side bracket makes the use of tools very easy and comfortable as there is plenty of space between the side and the allen wrench.

■ = STRESS INTENSITY LEVEL ON THE WALL

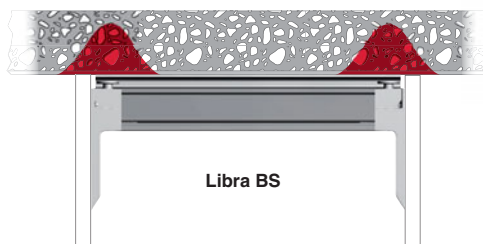

By adding intermediate hooks to Libra BS, the capacity loading is more evenly distributed, thus sensibly reducing the stress intensity level on the wall.

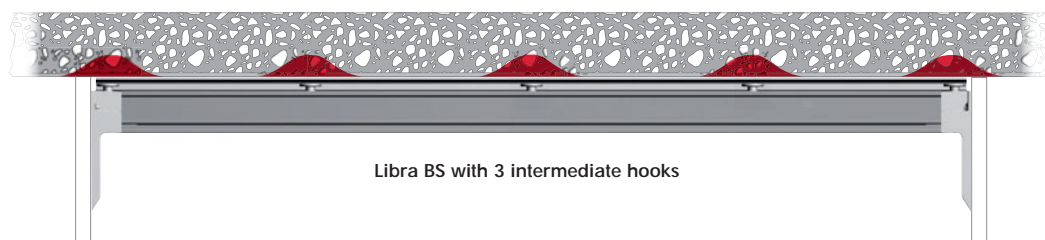
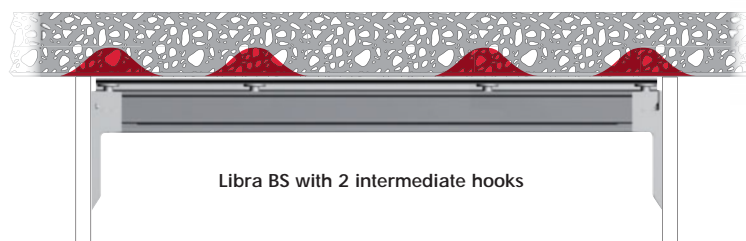
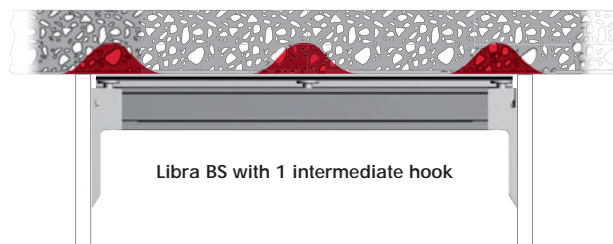

LIBRA BS



PATENTED

LIBRA BS is the innovative hanging system for suspended kitchen base units which require big capacity load as well as bumping loads.

LIBRA BS offers the customer the possibility to several hanging points on the wall, so that the load on every single wall plug is sensibly reduced, thus minimizing the risk of coming out of the wall.

A higher security standard is also guaranteed by the robustness of the wall bar, which, thanks to its thickness, gives the construction the highest stability thanks to its large supporting surface. From a security point of view, the placement of the fixing holes to the wall has been optimized. LIBRA BS is easily adjustable in vertical and in depth even when the base unit is already fixed to the wall.

To further improve the safety of LIBRA BS, the in-depth adjustment automatically activates the anti-turnover device.

LIBRA BS is the ideal system for very high loads, even with very deep constructions and particularly large and heavy drawers.



APPLICATION OF THE LIBRA BASE SYSTEM TO THE SUSPENDED BASE CABINET

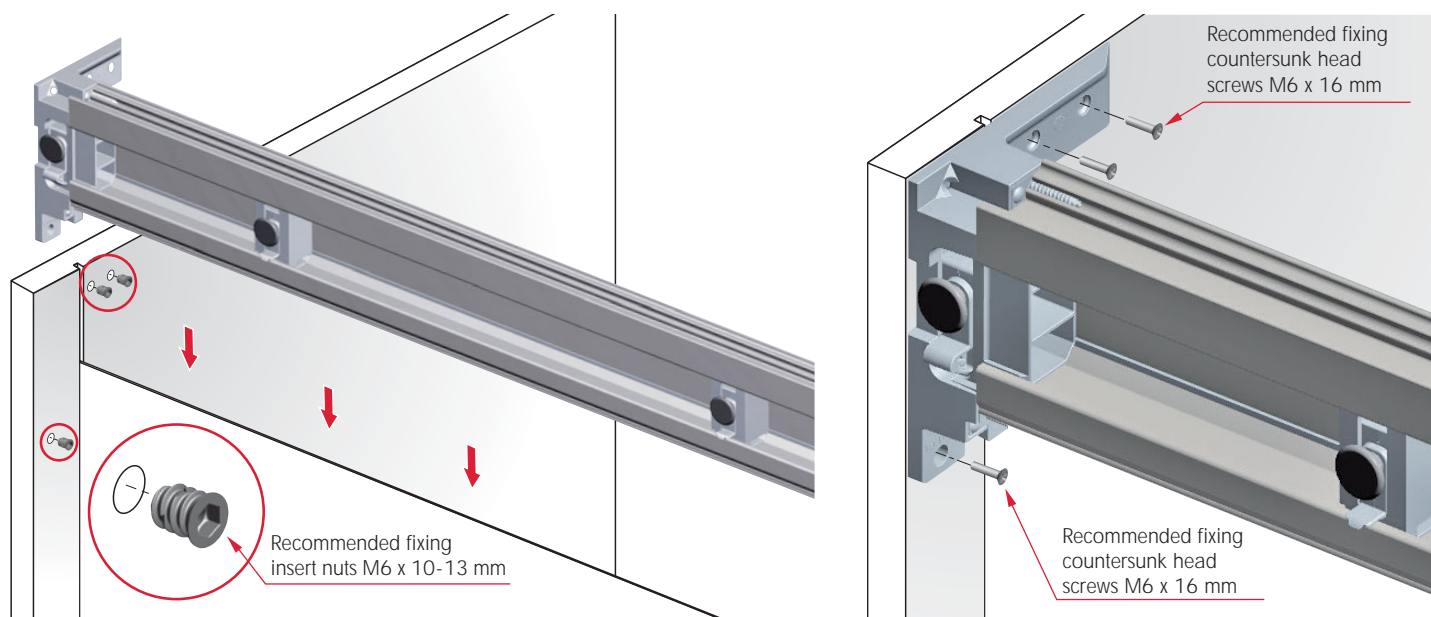

WALL BAR INSTALLATION AND CABINET HANGING

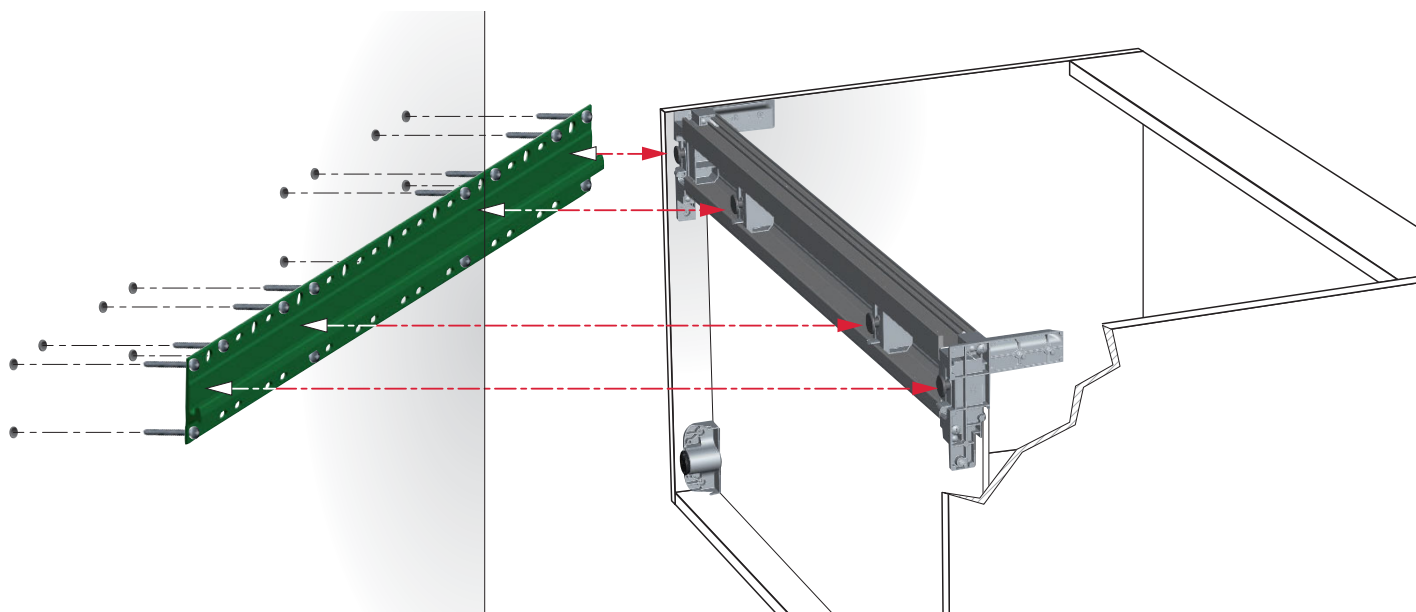

The fixing screws for the wall bar have to be aligned with the LIBRA Base System hanging hooks.

It is the responsibility of the customer:

- to ensure that the wall is of a suitable quality to hold the unit fixing in place.
- to use the proper hardware fittings according to the construction of the wall.

For more specific information, please refer to the WARNINGS section at the end of the catalogue.

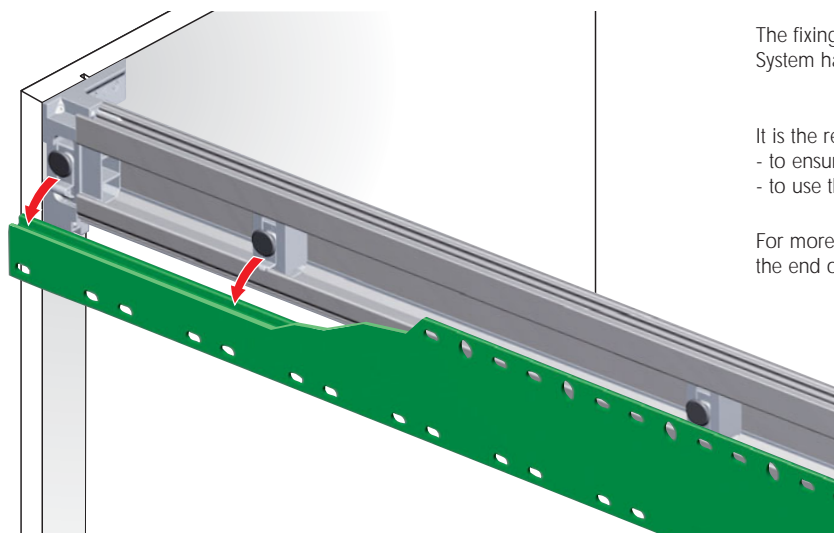

SIDE PANEL 15 - 16 MM THICK

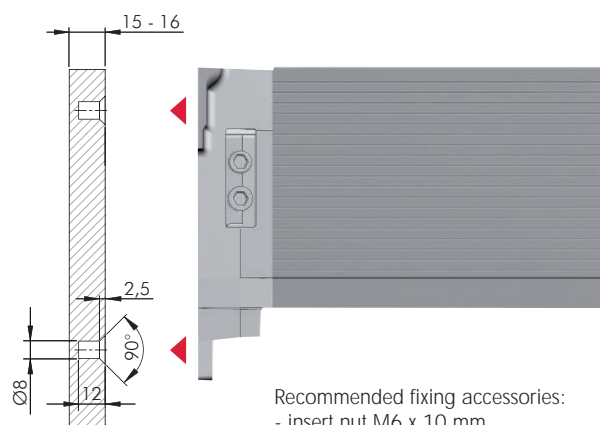

Recommended fixing accessories:
- insert nut M6 x 10 mm
- countersunk head screw M6 x 16 mm

SIDE PANEL 18 - 19 MM THICK

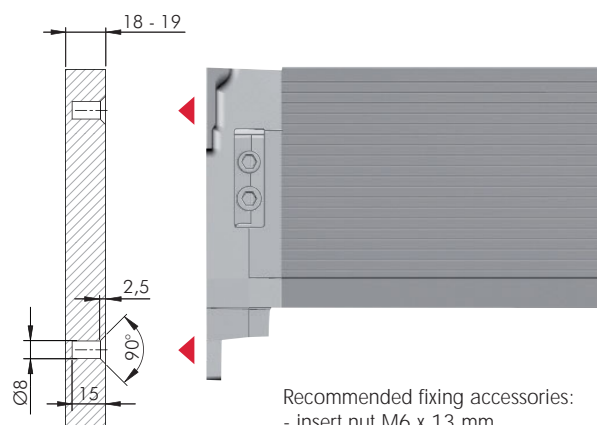

Recommended fixing accessories:
- insert nut M6 x 13 mm
- countersunk head screw M6 x 16 mm

SIDE PANEL DRILLING AND MILLING FOR VARIOUS BACK PANEL DIMENSIONS

BACK PANEL WOOD THICKNESS 4 MM
PLACED IN THE HIGHER SLOT

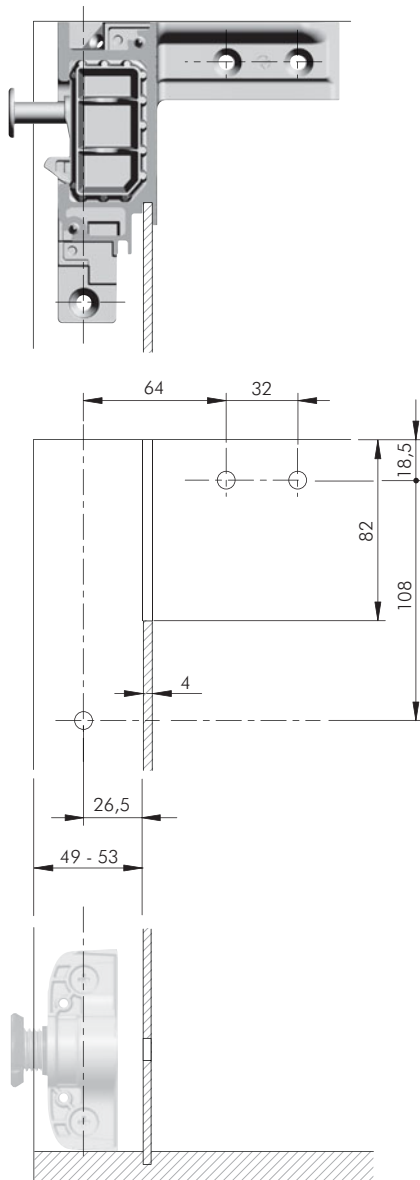

BACK PANEL WOOD THICKNESS 4 MM
PLACED IN THE LOWER SLOT

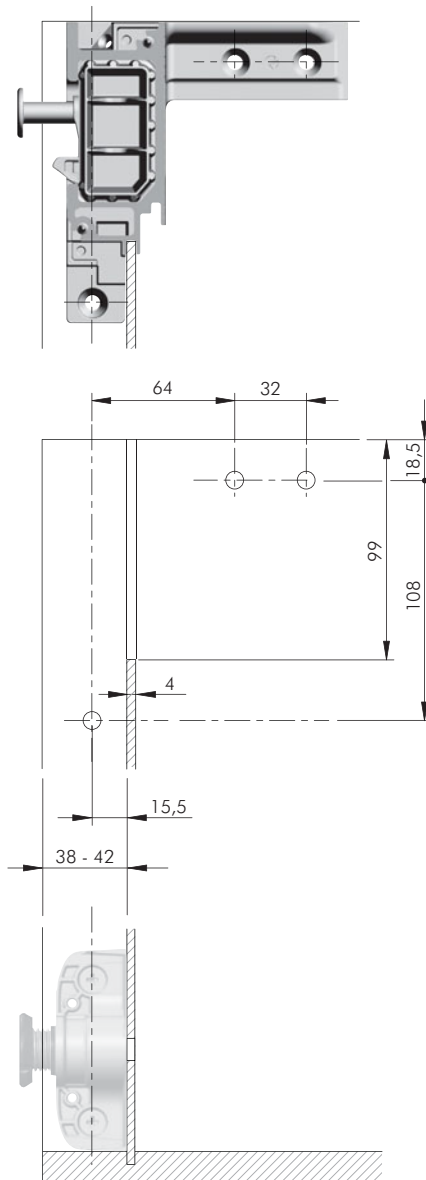

BACK PANEL WOOD THICKNESS 8 MM

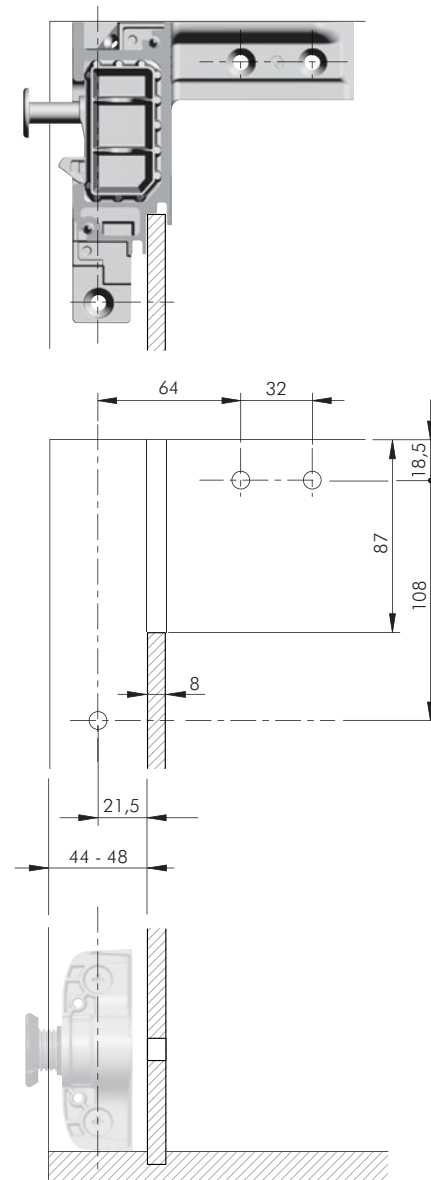

LIBRA BS WITH END ELEMENTS PRE-MOUNTED

READY FOR INSTALLATION

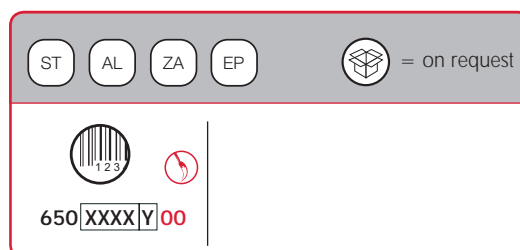

NOTE:

- LIBRA BS is supplied in carton box including 1 piece plus 1 LIBRA BS WALL BAR.
- LIBRA BS WALL BAR is supplied 10 mm shorter than LIBRA BS for lateral adjustment.

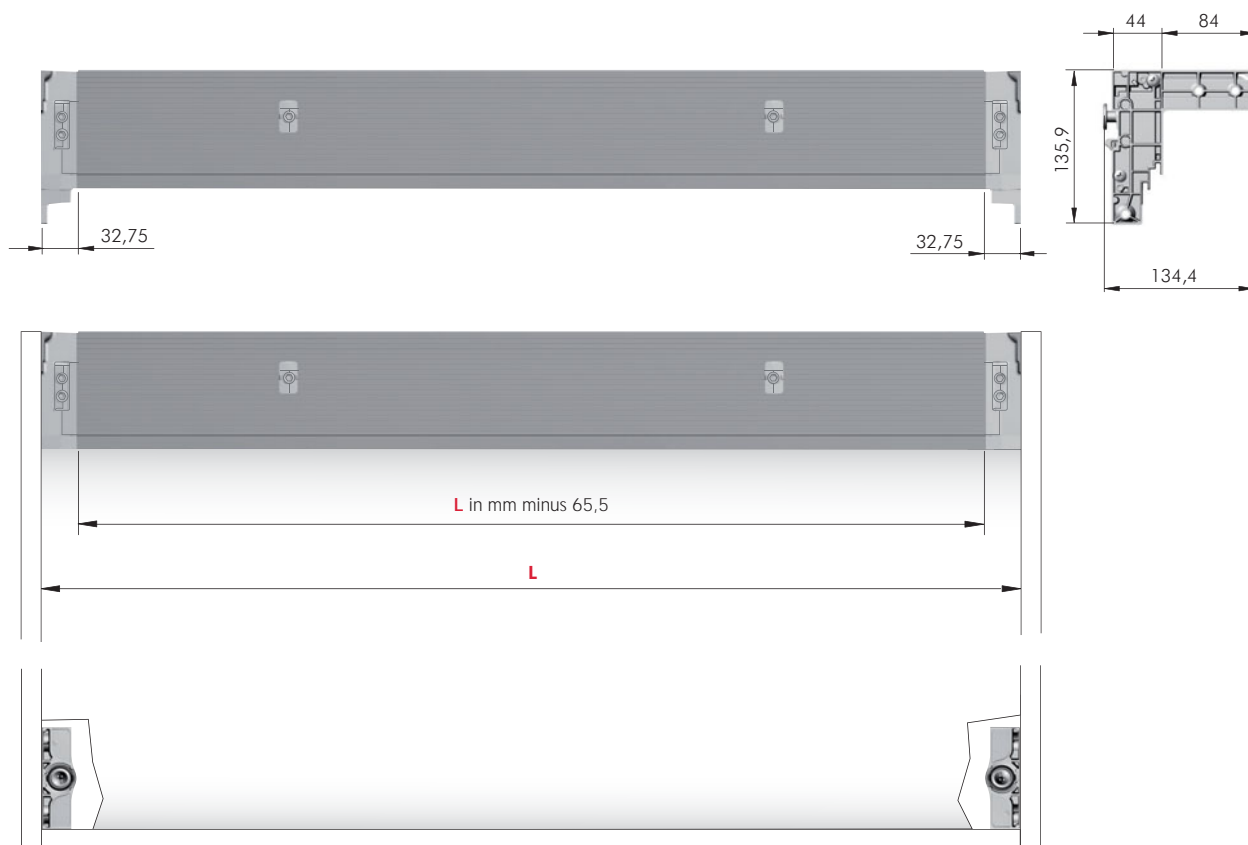

If **L** in mm is equal to a whole number use following code system:

L in mm minus 66 (which includes plus 0,5 tolerance)

650XXXXY00

- 0 = without intermediate pilot hook
- 1 = with 1 intermediate pilot hook
- 2 = with 2 intermediate pilot hooks
- 3 = with 3 intermediate pilot hooks

If **L** in mm is equal to a number ending with a plus 0,5 mm use following code system:

L in mm minus 65,5

650XXXXY00

- Z = without intermediate hook
- A = with 1 intermediate hook
- B = with 2 intermediate hooks
- C = with 3 intermediate hooks

SUGGESTED COMBINATIONS:





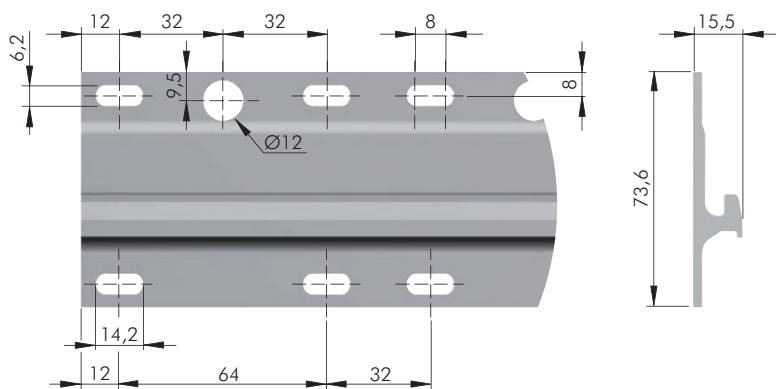
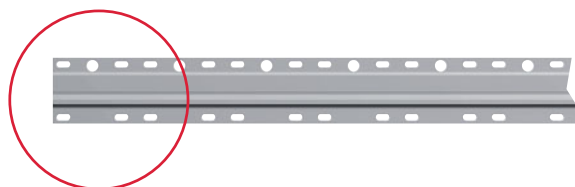



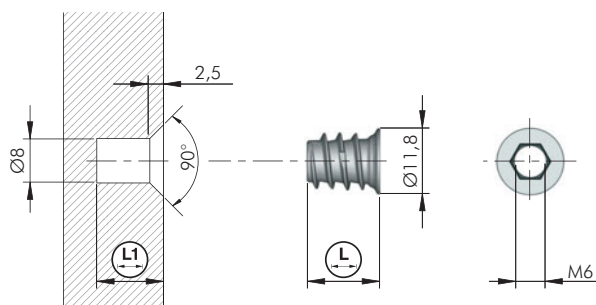

CABINET WIDTH (mm)	INTERMEDIATE HOOK
450	-
500	-
600	1
700	1
800	2
900	2
1000	2
1100	2
1200	3
1500	3

WALL BAR DETAIL







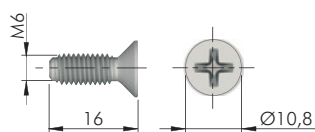

LIBRA BS FIXING ACCESSORIES







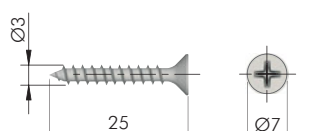

	= Ø 8 mm		= M6	+	
			= S6		
ZA					 = 5000 pcs.
					
20102010GR	10	12			
20102020GR	13	15			



		= M6		= PZ2	+	
ST						 = 500 pcs.
						
60308040ZN						



			= PZ2	+	
ST					 = 1000 pcs.
					
60101240 ZN					

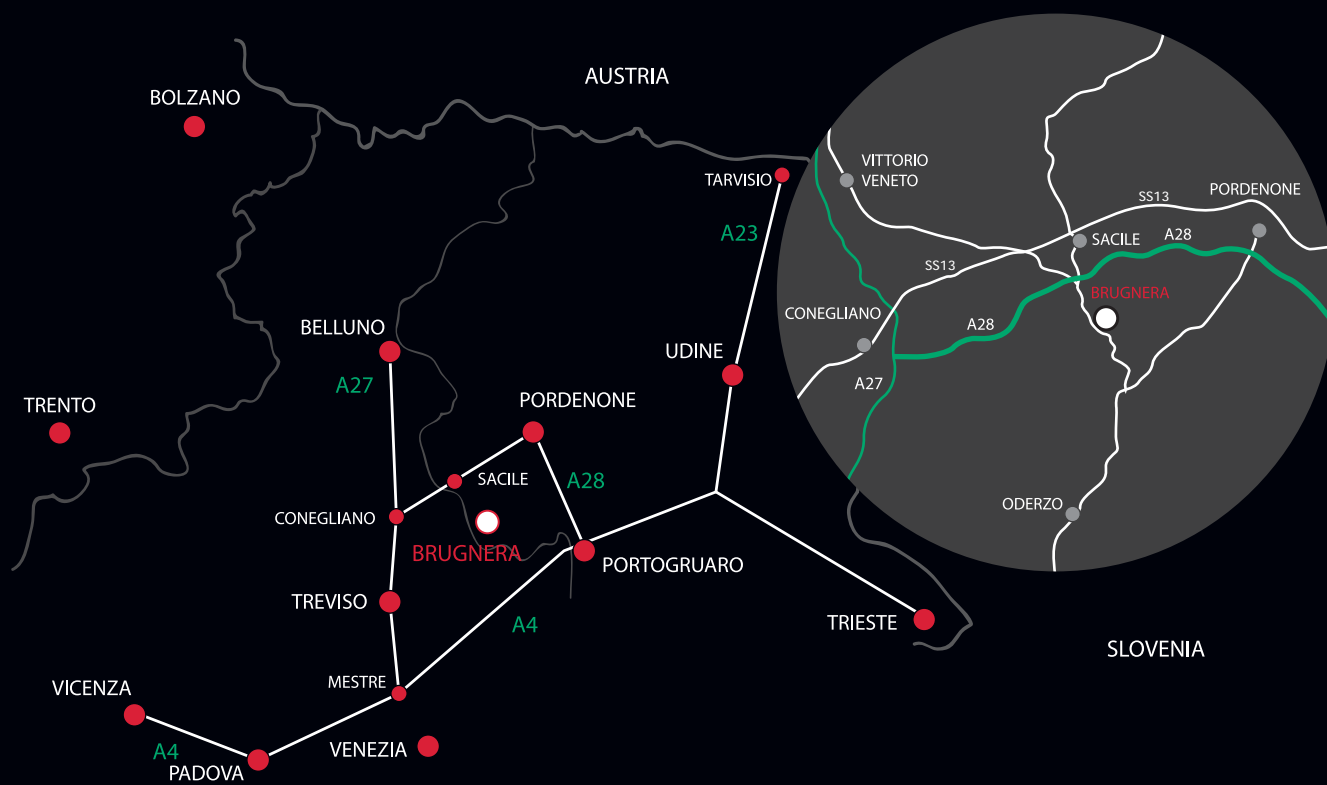

www.italianaferramenta.it