



# Kraby lid stay system

OPENING  
SYSTEMS  
FOR LIFT  
UP AND  
DROP  
DOWN  
DOORS





# SYMBOLS AND FINISHES LEGEND

## SYMBOLS

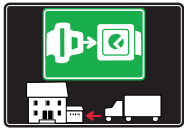

= SHELF SAFELY LOCKED DURING TRANSPORTATION AND AT HOME.



= ANTI-TURNOVER LOCKING SYSTEM



= NORMS / PATENTS



= PHILLIPS / POZIDRIV



= WITH BUFFER



= PART NO.



= BLADE SLOT



= WITH MAGNET



= PCS. PER PACKAGE



= COMBI SLOT



= HEXAGONAL SOCKET



= NEWTON



= CAPACITY LOADING



= HEXALOBULAR SOCKET



= FRICTION



= WOOD / GLASS THICKNESS



= COUNTERSUNK HEAD



= AUTOMATIC



= HOLE DIAMETER



= PAN HEAD



= DROP DOWN



= DIAMETER



= FLANGE HEAD



= LENGTH



= FLAT HEAD



= STANDARD HINGE



= HEIGHT



= TRILOBULAR SCREW



= KIMANA HINGE



= RIGHT VERSION



= SELF-TAPPING SCREW



= FLAP HINGE



= LEFT VERSION



= EURO THREAD



= WITH SPRING



= SETTING CODE



= METRIC THREAD



= WITHOUT SPRING



= PCS. PER PAD



= PRE-INSERTED SCREW



= REVERSED SPRING



= CUT ON REQUEST



= PRE-INSERTED SCREW AND SPREADING BUSH



= SELF ADHESIVE



= WITH FLANGE

NOTE: Printing errors and omissions may exist despite our best efforts to ensure accuracy. We reserve the right to alter specifications without notice.

## MATERIALS

**ZA** = Zinc Alloy

**ST** = Steel

**HSS** = High Speed Steel

**BR** = Brass

**ABS** = Acrylonitrile Butadiene Styrene

**ZAnk** = Nickel-plated Zinc Alloy

**STzk** = Zinc-plated Steel

**AL** = Aluminium

**WD** = Wood

**EVA** = Ethylene Vinyl Acetate

**EP** = **ENGINEERING PLASTIC**

+ **EP** = other engineering plastic available on request

**SR** = **SOFT RUBBER**

+ **SR** = other soft rubber available on request

**EPn** = Natural Engineering Plastic

**EPc** = Clear Engineering Plastic

**SRn** = Natural Soft Rubber

**EPw** = White Engineering Plastic

**EPg** = Grey Engineering Plastic

**SRw** = White Soft Rubber

**EPwg** = Water Green Engineering Plastic

**EPa** = Anthracite Engineering Plastic

**SRb** = Black Soft Rubber



## FINISHES



+ **OTHER FINISHES AVAILABLE ON REQUEST**

PART NO.	FINISHES	PART NO.	FINISHES	PART NO.	FINISHES
00	Insignificant finish	IF	Middle Grey	RO	Red
AA	Natural	IJ	Light Grey	UT	T-Met 9007
AB	White	IL	Grey 20	UZ	T-Met
AE	White 9010	IN	Grey met. 26	WA	Bronzed
EA	Black	JB	Bright Aluminium	WI	Burnished
EC	Matt Black	JC	Aluminium - Chrome	XD	Satin-finished Steel
EE	Anthracite	JD	Matt Aluminium	YA	Nickel-plated
EW	Grey 9007	JE	Satin-finished Aluminium	YB	Bright Nickel-plated
FU	Gunmetal	JF	Aluminium - Brass	YC	Matt Nickel-plated
FV	Gunmetal V52	JG	Aluminium 5	YD	Satin-finished Nickel-plated
GR	Raw	JL	Aluminium PE 11	YQ	Black Nickel
HA	Brass-Plated	JM	Aluminium RAL 9006	Z9	Black Zinc
HH	Tropicalized	KA	Chrome	ZA	Zinc alloy
HL	Raw Brass	KB	Bright Chrome	ZN	Zinc-plated
HX	Graphite	KC	Matt Chrome	ZQ	Bright Gold
IA	Grey	LD	Brown 8019	ZY	Titanium
IB	Metallic Grey	NN	Metallic Beige	ZZ	Clear

## KRABY SYSTEM LIFT UP

KRABY is a gas and oil stay to open flap doors. It has been conceived to be installed by using standard automatic drilling processes. It is available in three different lengths and several newton strengths to suit doors of any size. It can be fixed directly on solid doors or wider aluminium frame section doors. For small aluminium sections a range of special adaptors is available. KRABY is available in:

- Automatic version: once you open the door, it continues to open gently and completely by itself.
- Friction version: once you open the door, the stay holds the door in any required position.

KRABY offers some relevant benefits:

- The rotary knob placed on the piston base plate can be used to adjust the opening angle and therefore to align nearby doors.
- By adjusting the position of the piston base plate within the "U" slot of the side bracket, it is possible to change the time in opening and closing of the door

All the parts (stay excluded) are in zinc alloy nickel plated and engineering plastic.



FRICION VERSION



AUTOMATIC VERSION



*PATENTED*  
Certificates available on request.



### INSTALLATION



#### VERY IMPORTANT

The door bracket has to be placed in vertical position with the slot facing forwards.

recommended fixing countersunk head wood screws Ø3,5x16 mm or Euro thread screws.

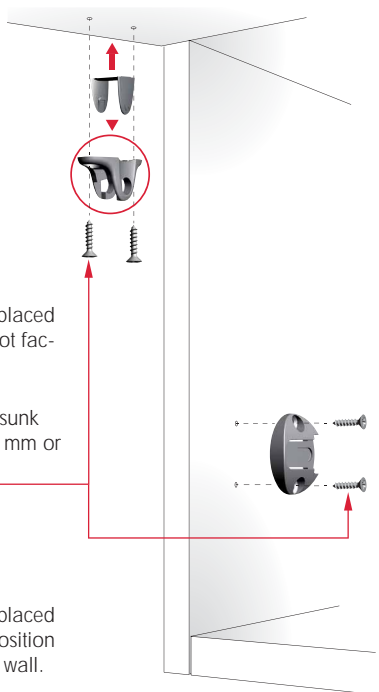

#### VERY IMPORTANT

The side bracket has to be placed with the slot in horizontal position and the open end facing the wall.

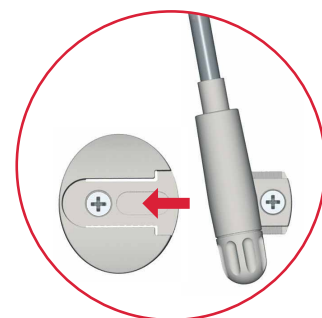
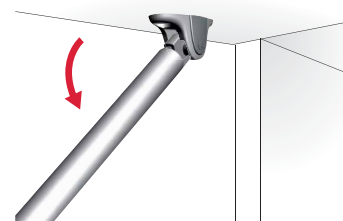
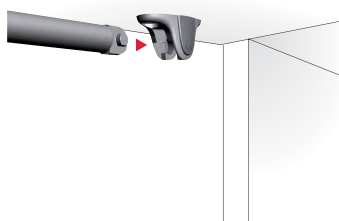

### ADJUSTMENTS

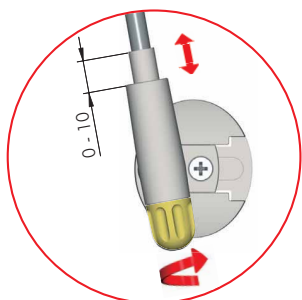

#### INCREASE OPENING ANGLE

Rotate the rotary knob.

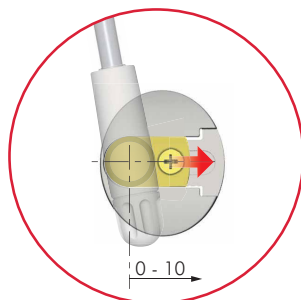

#### REDUCE OPENING ANGLE

Move forward and backward the piston base plate in the bracket slot.

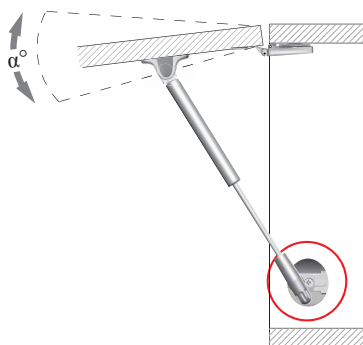

### LOCKING

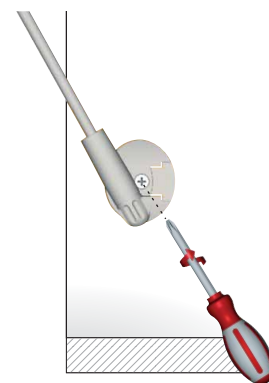



**LIFT UP**

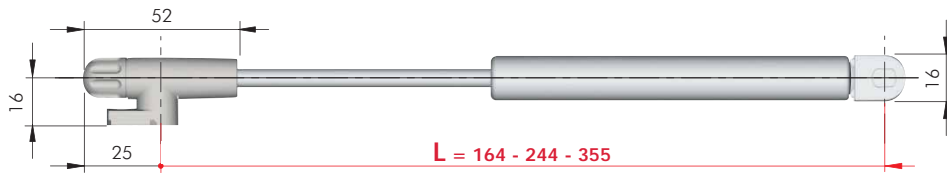
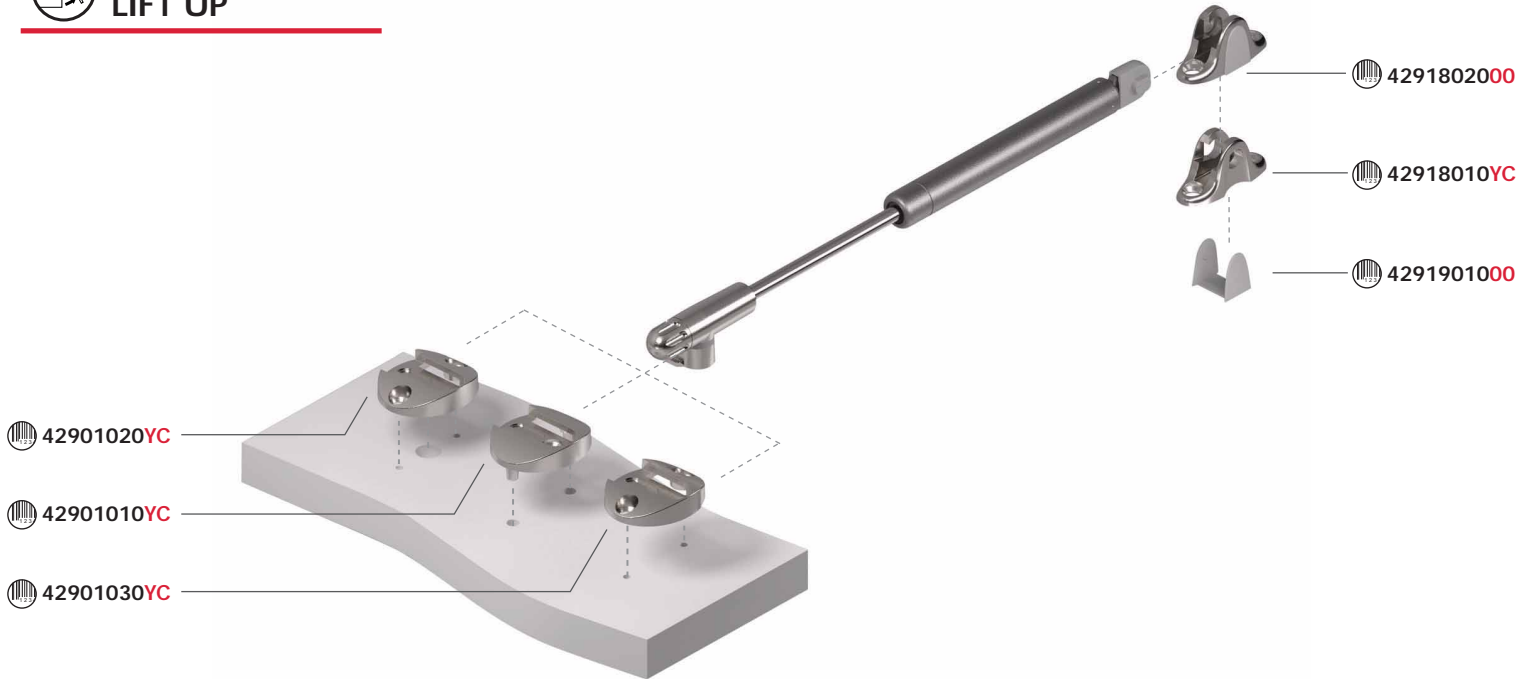

ZAnk EP ST

= 100 pcs.

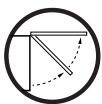

**KRABY FRICTION VERSION**

Further newton strengths available on request.

L			N
164	42001010UZ		45
	42002010UZ		60

L			N
244	42011010UZ		45
	42012010UZ		60
	42013010UZ		90
	42014010UZ		120

L			N
355	42030010UZ		45
	42031010UZ		60
	42032010UZ		90
	42033010UZ		120

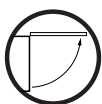

**KRABY AUTOMATIC VERSION**

Further newton strengths available on request.

L			N
164	42101010UZ		50
	42102010UZ		80
	42103010UZ		120

L			N
244	42110010UZ		50
	42111010UZ		80
	42112010UZ		100
	42113010UZ		120
	42114010UZ		140

L			N
355	42130010UZ		50
	42131010UZ		80
	42132010UZ		100
	42133010UZ		120

## Number of stays chart - L 164 mm

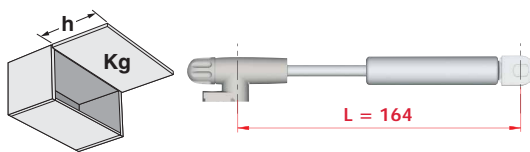

Rev. 02

h	Kraby version	Door weight (Kg)										Kraby version			
		1	2	3	4	5	6	7	8	9	10				
230 - 274	Automatic	1x80N	2x80N	2x120N	3x120N	4x120N									Automatic
	Friction	1x45N	2x45N		2x60N		3x60N							Friction	
275 - 325	Automatic	1x80N	2x80N	2x120N	3x120N	4x120N								Automatic	
	Friction	1x60N	2x45N		2x60N		3x60N		4x60N					Friction	

## Number of stays chart - L 244 mm

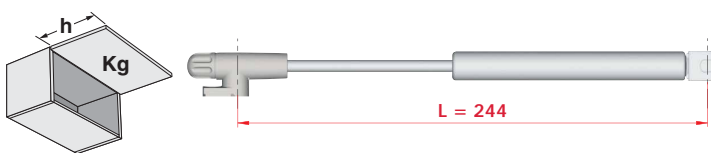

Rev. 02

h	Kraby version	Door weight (Kg)													Kraby version
		1	2	3	4	5	6	7	8	9	10	11	12	13	
300 - 324	Automatic	1x80N	2x50N	2x80N	2x100N	2x120N	2x140N	2x160N*						Automatic	
	Friction	1x45N	1x60N	2x45N		2x60N		2x90N					Friction		
325 - 374	Automatic	1x80N	2x50N	2x80N	2x100N	2x120N	2x140N	2x160N*	2x180N*					Automatic	
	Friction	1x45N	1x60N	2x45N		2x60N		2x90N			2x120N			Friction	
375 - 424	Automatic	1x80N	2x50N	2x80N	2x100N	2x120N	2x140N	2x160N*	2x180N*	2x240N*			Automatic		
	Friction	1x45N	1x60N	2x45N		2x60N		2x90N		2x120N				Friction	
425 - 474	Automatic	2x50N		2x80N		2x100N	2x120N	2x140N	2x160N*	2x180N*	3x160N*		Automatic		
	Friction	1x60N		2x45N		2x60N		2x90N		2x120N		3x90N		Friction	
475 - 524	Automatic	2x80N		2x100N	2x120N	2x140N	2x160N*	2x180N*	3x160N*			Automatic			
	Friction	2x45N		2x60N		2x90N		2x120N		3x90N		3x120N		Friction	

\* Strenghs available on request.

## Number of stays chart - L 355 mm

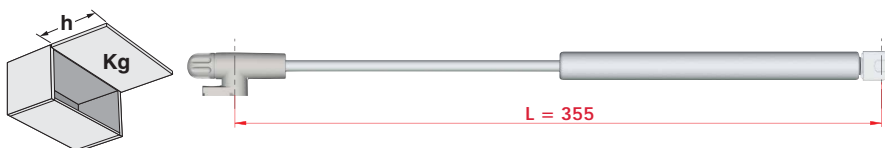

Rev. 02

h	Kraby version	Door weight (Kg)													Kraby version
		1	2	3	4	5	6	7	8	9	10	11	12	13	
400 - 424	Automatic	1x80N		2x50N		2x80N		2x100N		2x120N		2x160N		Automatic	
	Friction	2x45N					2x60N								Friction
425 - 474	Automatic	1x80N	2x50N	2x80N		2x100N		2x120N		2x160N				Automatic	
	Friction	2x45N					2x60N				2x90N				Friction
475 - 524	Automatic	1x80N	2x50N	2x80N		2x100N	2x100N	2x160N		2x180N		2x200N		Automatic	
	Friction	2x45N					2x60N				2x90N				Friction
525 - 574	Automatic	1x80N	2x50N	2x80N		2x100N	2x100N	2x160N		2x180N		2x200N		Automatic	
	Friction	2x45N					2x60N				2x90N				Friction
575 - 624	Automatic	2x50N		2x80N		2x100N	2x120N	2x160N		2x180N	2x200N			Automatic	
	Friction	2x45N					2x60N				2x90N				Friction
625 - 700	Automatic	2x50N		2x80N		2x100N	2x120N	2x160N		2x180N	2x200N			Automatic	
	Friction	2x45N			2x60N			2x90N		2x120N				Friction	

These are experimental results to be checked by the customer. Our Technical Department is at your disposal to test further cases out of this charts.



KRABY CONFIGURATOR:



## LIFT UP DRILLING PLANS WITH STANDARD HINGES OPENING WITH HANDLE

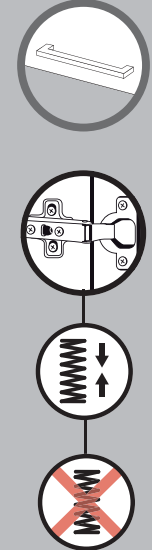

L 164 mm

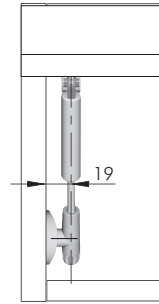
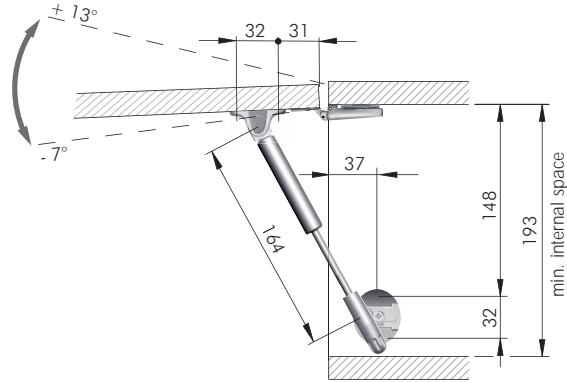

L 244 mm

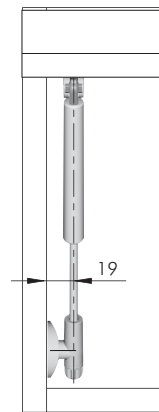
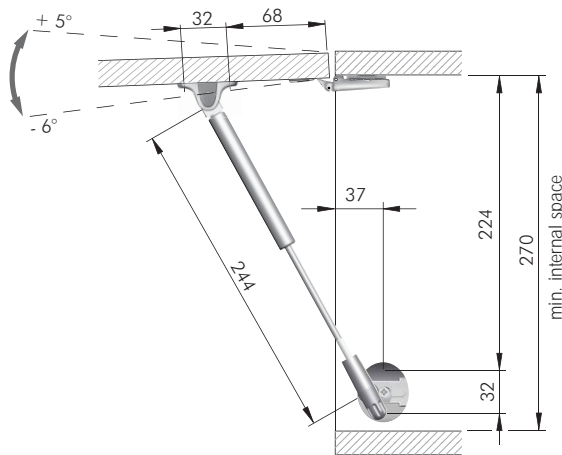

L 355 mm

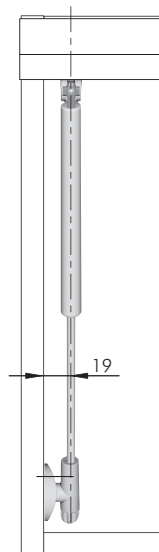
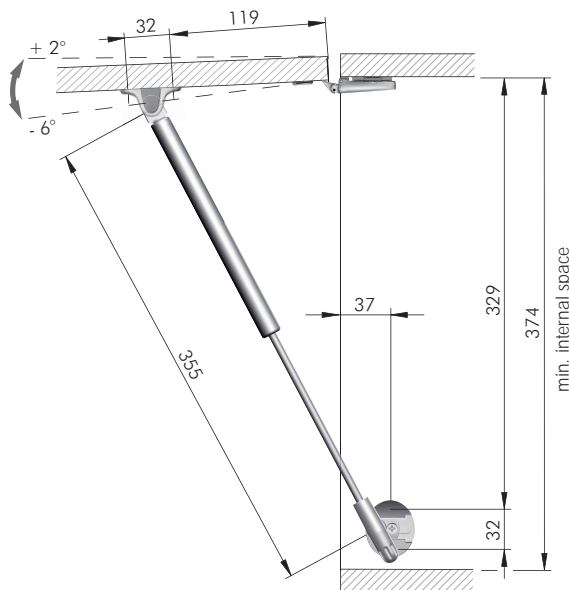

The dimensions of the above drilling plans refer to carcasses which use **standard sprung or unsprung hinges** and mounting plates 0 mm. Please note that the opening angle shown data is purely indicative. It varies with respect to the hinge brand and adjustment carried out.



Please note that in case of use of **unsprung hinges**, magnet K Lock is required. For details refer to section "PUSH CATCHES & MAGNETIC CATCHES".



## LIFT UP DRILLING PLANS WITH STANDARD HINGES PUSH TO OPEN



L 164 mm

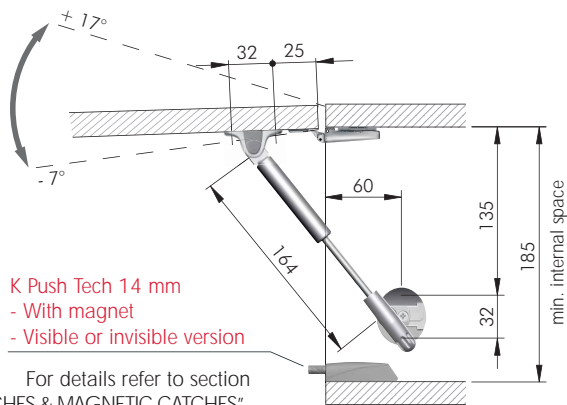

**K Push Tech 14 mm**  
- With magnet  
- Visible or invisible version

For details refer to section "PUSH CATCHES & MAGNETIC CATCHES".

L 244 mm

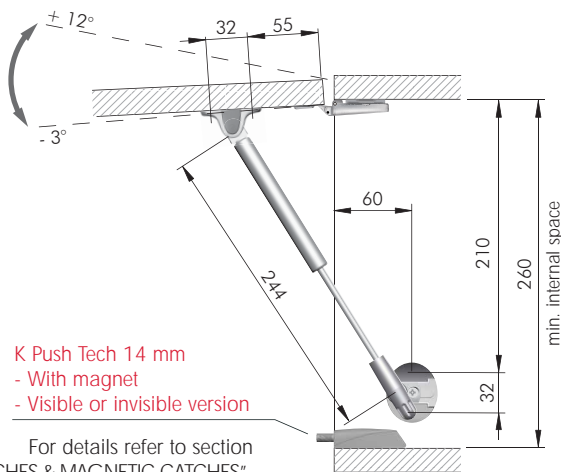

**K Push Tech 14 mm**  
- With magnet  
- Visible or invisible version

For details refer to section "PUSH CATCHES & MAGNETIC CATCHES".

L 355 mm

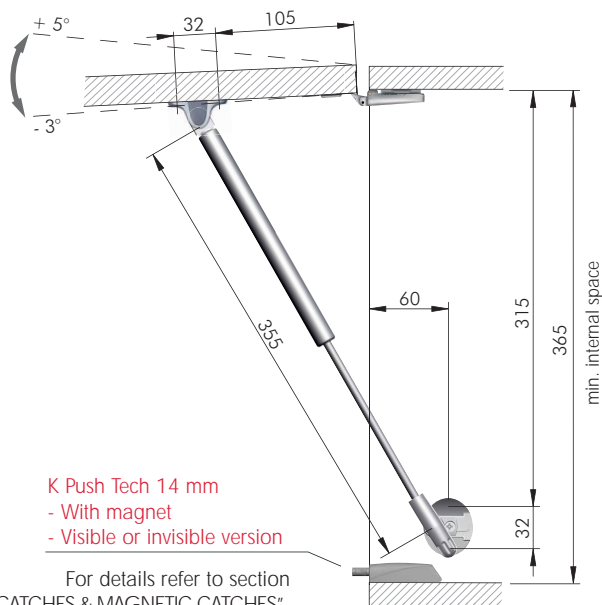

**K Push Tech 14 mm**  
- With magnet  
- Visible or invisible version

For details refer to section "PUSH CATCHES & MAGNETIC CATCHES".

The dimensions of the above drilling plans refer to carcasses which use **standard unsprung hinges** and mounting plates 0 mm. Please note that the opening angle shown data is purely indicative. It varies with respect to the hinge brand and adjustment carried out.

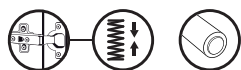

Please note that utilization with **standard sprung hinges** and **K Push Tech with buffer** is also possible. In such case, after the door is initially released by K Push Tech, a manual opening approx. 7cm is required (in order to win the spring resistance). Consequently, the door will automatically open to the fullest.  
For details refer to section "PUSH CATCHES & MAGNETIC CATCHES".





## KRABY FOR STORAGE CHEST OPENING

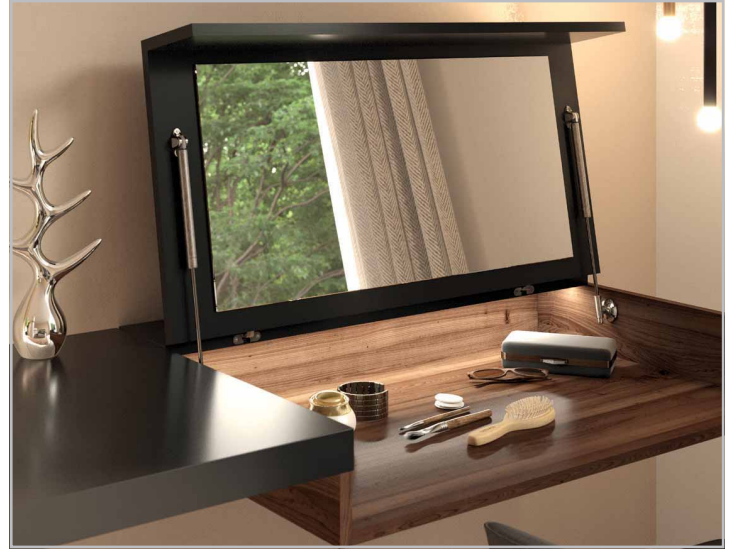
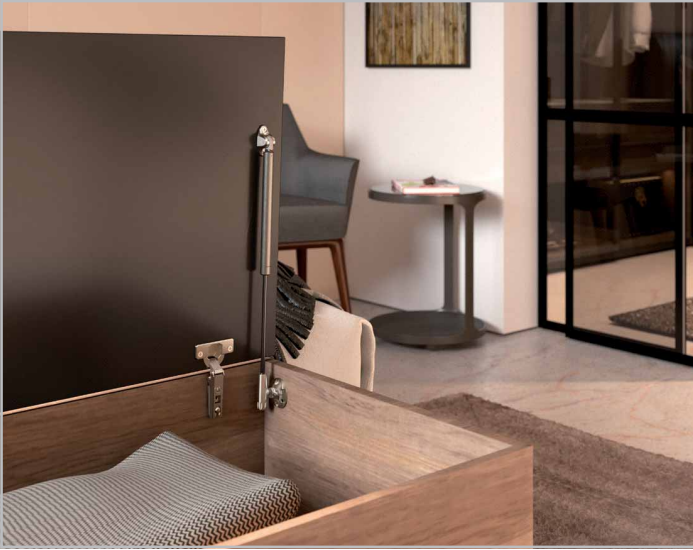

### INSTALLATION

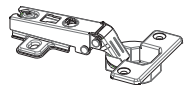
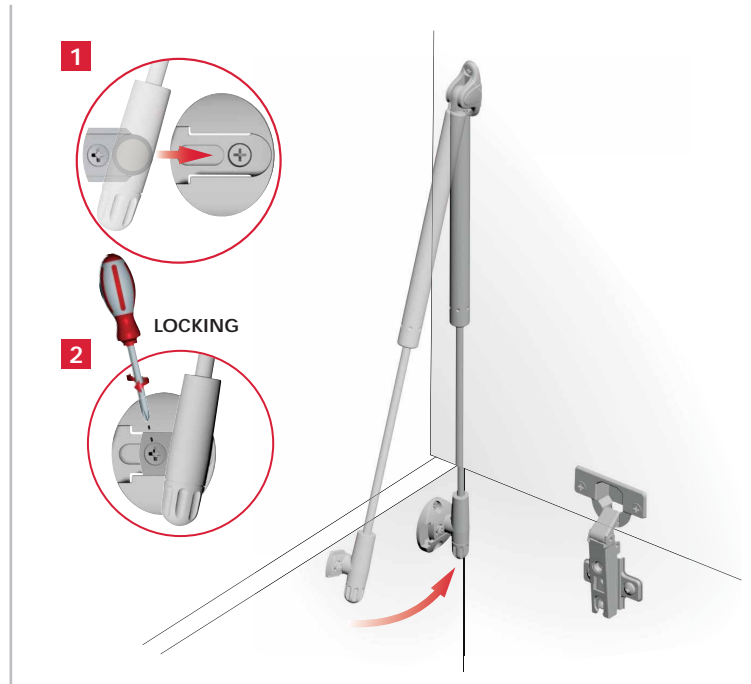
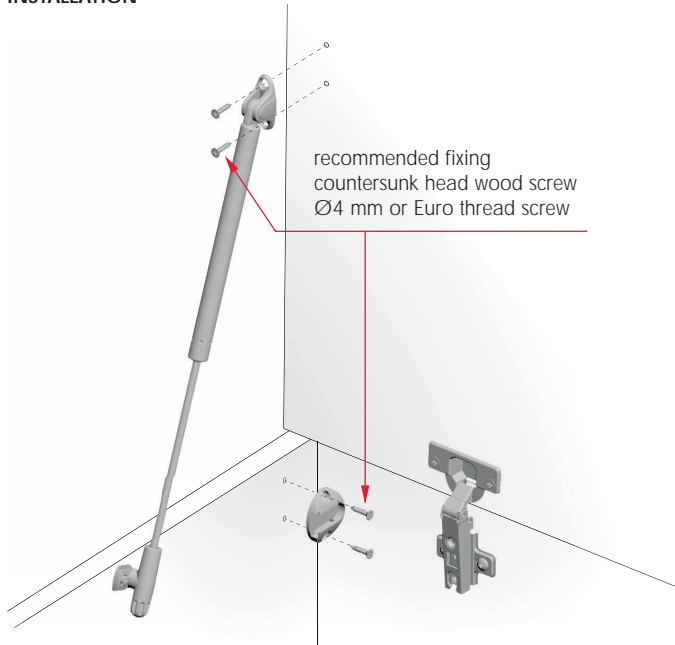

Using standard spring hinges with integrated dumper further enhances the soft closing effect.

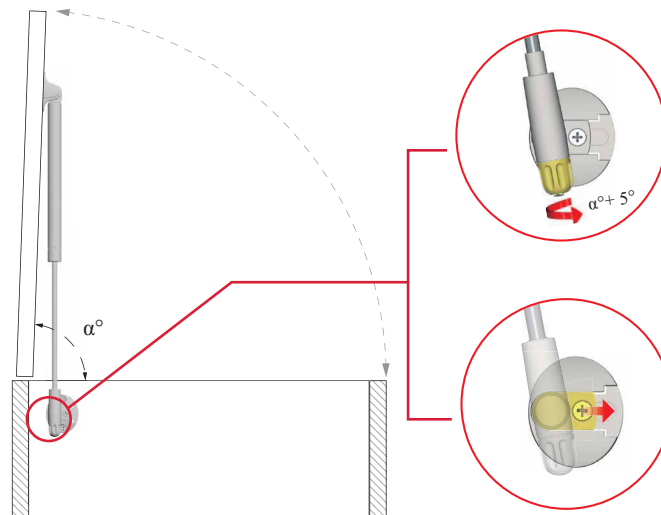
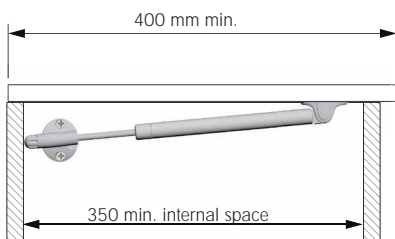

INCREASE OPENING ANGLE

SOFT CLOSE ADJUSTMENT

## DRILLING PLAN WITH STANDARD HINGES

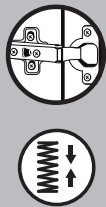

### HAND OPENING

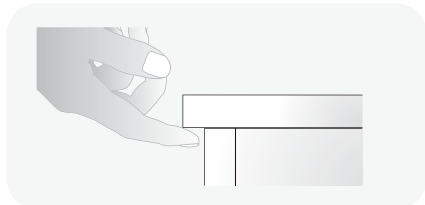

### OPENING WITH K PUSH TECH

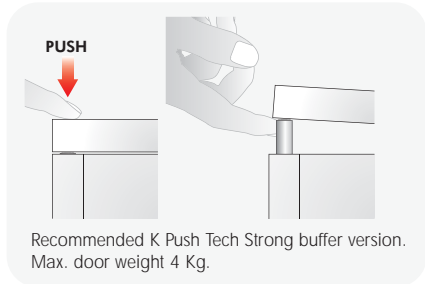

Recommended K Push Tech Strong buffer version.  
Max. door weight 4 Kg.

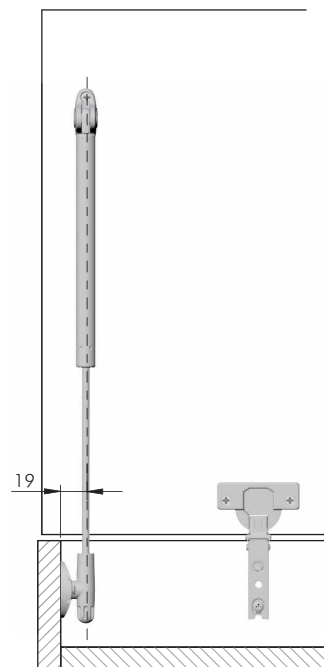
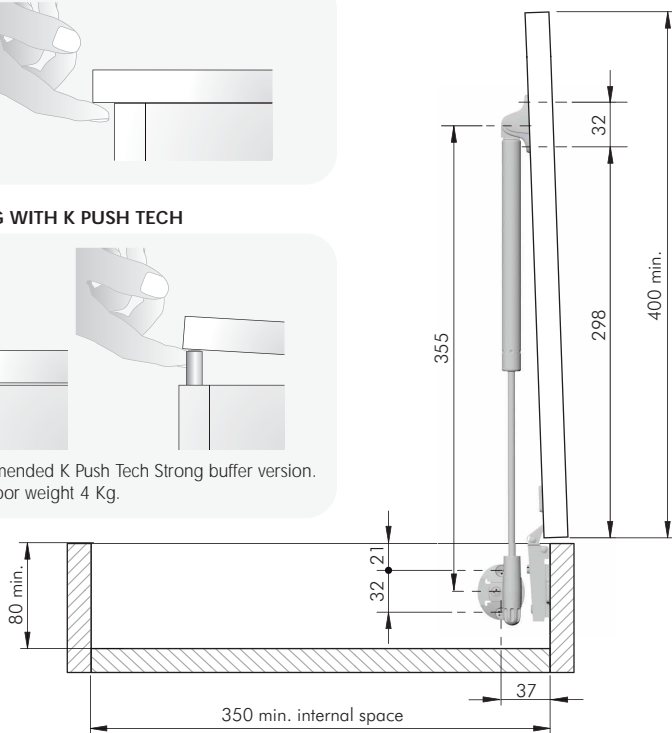

NOTE: Using standard spring hinges with integrated dumper further enhances the soft closing effect.

This drilling plan is intended for reference only. Each application may need minor variations in the placement of the holes; these variations should be evaluated and tested by the customer on a sample cabinet.

## Number of stays chart

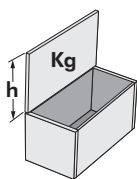

## Friction opening chart

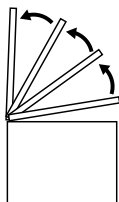

h	Door weight (Kg)												
	1	2	3	4	5	6	7	8	9	10	11	12	13
400 - 474	-	1x45N		2x45N		2x60N			2x90N		-	-	-
475 - 549	-	1x90N	2x45N		2x60N		2x90N		-	-	-	-	-
550 - 600	-	1x90N	2x60N			2x90N		-	-	-	-	-	-

These are experimental results to be checked by the customer.

## Automatic opening chart



h	Door weight (Kg)												
	1	2	3	4	5	6	7	8	9	10	11	12	13
400 - 474	-	1x80N	1x100N	2x80N		2x100N		2x120N		-	-	-	-
475 - 549	-	1x120N		2x80N	2x100N	2x120N		-	-	-	-	-	-
550 - 600	-	-	2x100N		2x120N		-	-	-	-	-	-	-

These are experimental results to be checked by the customer.



## DRILLING PLAN WITH CONCEALED HINGES

### HAND OPENING

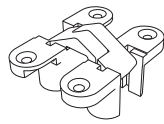
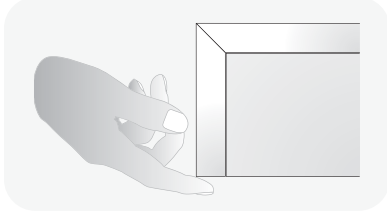

With concealed hinges is recommended to use KRABY friction version.

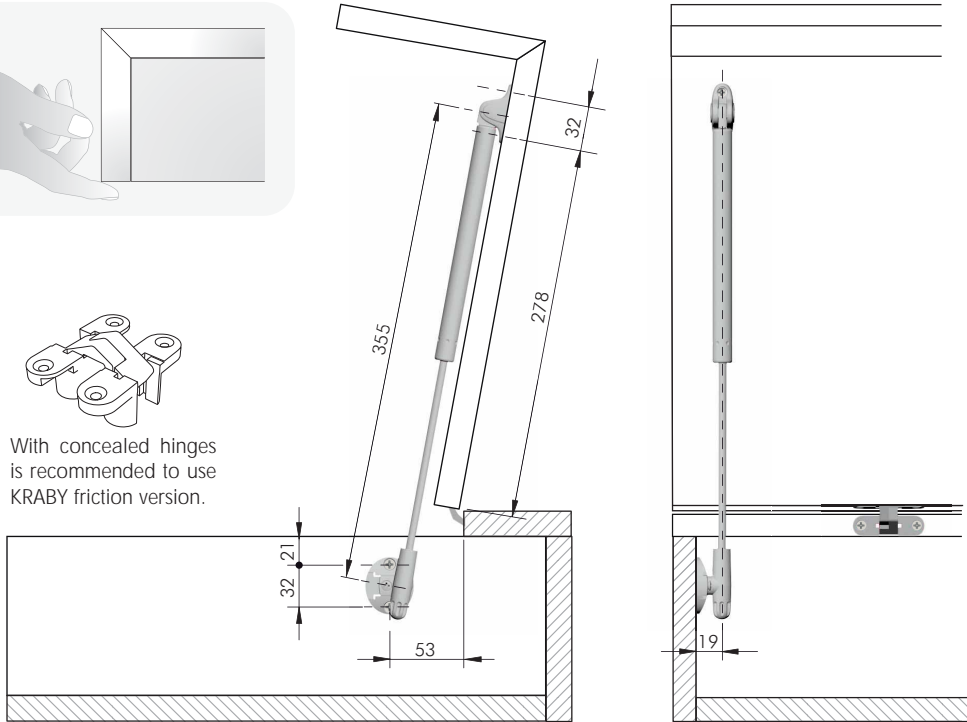

This drilling plan is intended for reference only. Each application may need minor variations in the placement of the holes; these variations should be evaluated and tested by the customer on a sample cabinet.

## Number of stays chart

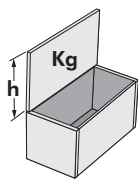

## Friction opening chart

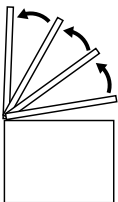

h	Door weight (Kg)													
	1	2	3	4	5	6	7	8	9	10	11	12	13	
400 - 474	-	1x45N		2x45N			2x60N		2x90N					-
475 - 549	-	1x60N	2x45N	2x60N		2x90N		-	-	-	-	-	-	
550 - 600	-	2x45N		2x60N		2x90N		-	-	-	-	-	-	

These are experimental results to be checked by the customer.



ZAnk EP ST = 50 pcs.

KRABY FRICTION VERSION				KRABY AUTOMATIC VERSION			
L	Barcode	Icon	N	L	Barcode	Icon	N
355	42030030UZ		45	355	42131030UZ		80
	42031030UZ		60		42132030UZ		100
	42032030UZ		90		42133030UZ		120

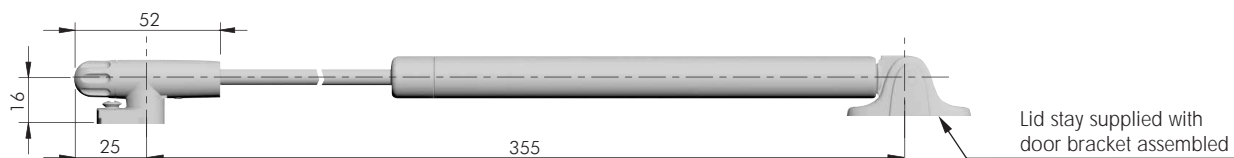

## SIDE BRACKET

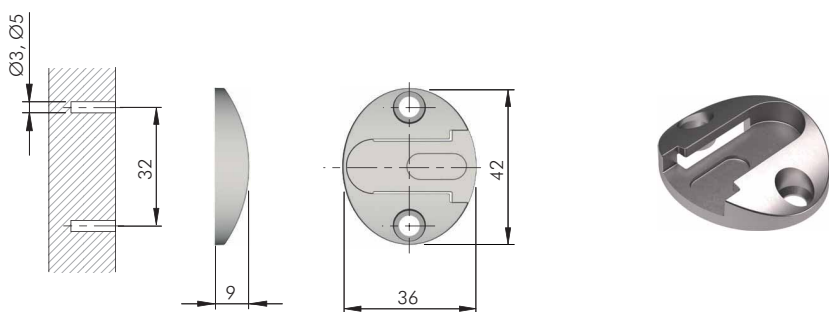

Ø 3, Ø 5 mm = 100 pcs.

ZA







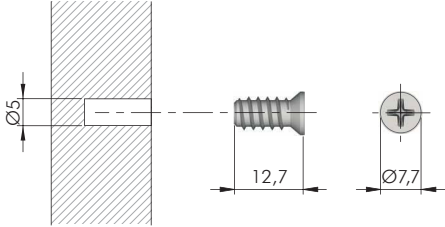

Barcode

**42901030YC**









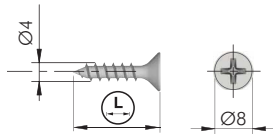



## FIXING ACCESSORIES



 = Ø 5 mm	+ 
   = PZ2	
ST	 = 5000 pcs.
 123	
<b>60501050YA</b>	



 = Ø 2,5 mm	+ 
   = PZ2	
ST	 = 10.000 pcs.
 123	
<b>60101570YA</b>	 16
<b>60101580YA</b>	 18

## KRABY SYSTEM DROP DOWN

KRABY is an oil stay to open drop down doors. It has been conceived to be installed by using standard automatic drilling processes.

It is available in three different lengths and with a universal "Zero" N strength, to suit any door dimension and weight.

It boasts smooth and elegant movement to gently open the doors downwards. The opening angle adjustment can be carried out manually through the rotary knob, thus allowing to align nearby doors easily.

The adjustment of the piston base plate within the "U" slot of the side bracket can change the door opening.

KRABY grants a quick and easy installation, with no need to tension the strength.

Directly installed on solid or wider aluminium frame doors and wide range of special adapters to suit small aluminium door profiles.

All the parts (stay excluded) are in zinc alloy nickel plated and plastic.

**PATENTED**  
Certificates available on request.



### INSTALLATION

recommended fixing countersunk head wood screws Ø3,5x16 mm or Euro thread screws

#### VERY IMPORTANT

The side bracket has to be placed with the slot in horizontal position and the open end facing the wall.



#### VERY IMPORTANT

The door bracket has to be placed in vertical position with the slot facing forwards.

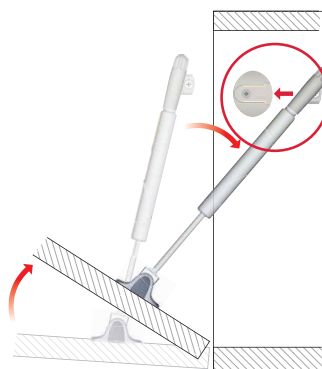
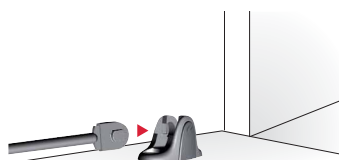
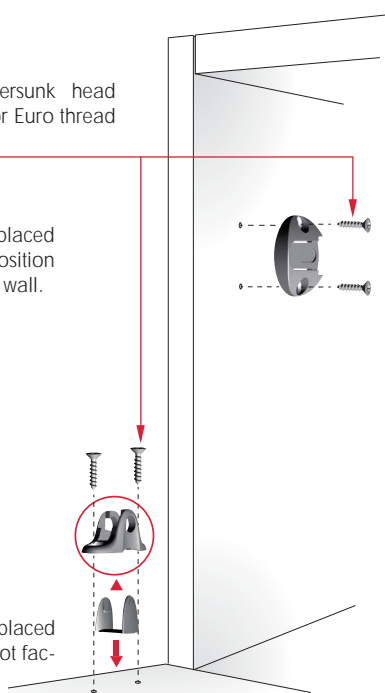

### ADJUSTMENTS

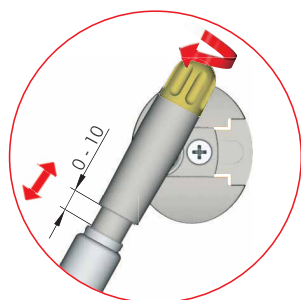

**INCREASE OPENING ANGLE**  
Rotate the rotary knob.

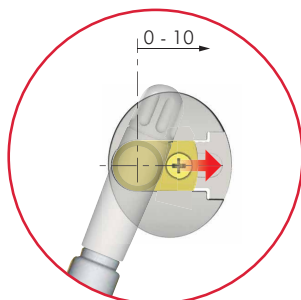

**REDUCE OPENING ANGLE**  
Move forward and backward the piston base plate in the bracket slot.

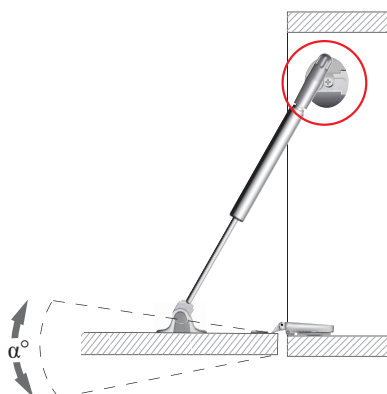

### LOCKING

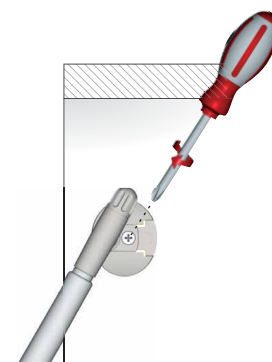



**DROP DOWN**

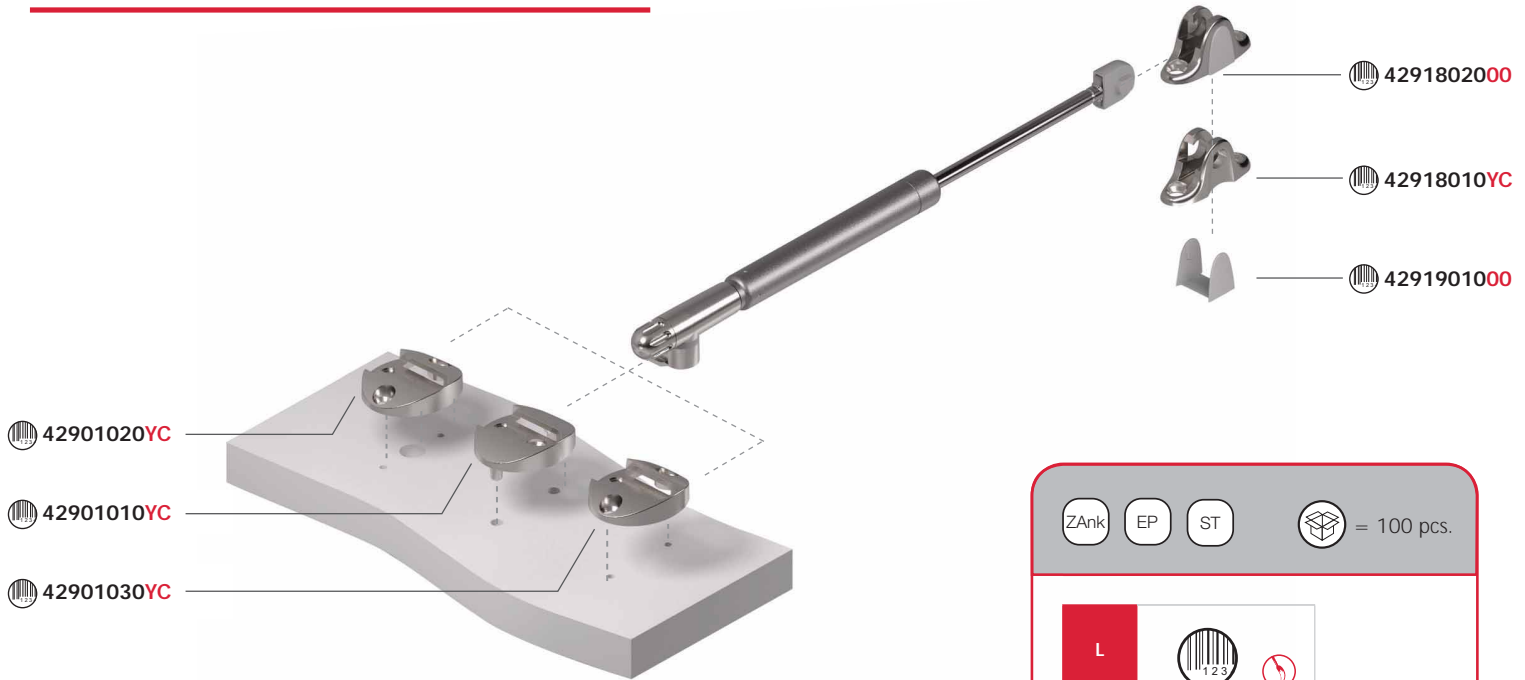

ZAnk	EP	ST	= 100 pcs.
<b>L</b>			
<b>164</b>	<b>42201010UZ</b>		
<b>244</b>	<b>42210010UZ</b>		
<b>355</b>	<b>42230010UZ</b>		

**Number of stays chart - L 164 mm**

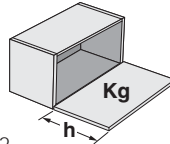

Rev. 02

h	Door weight (Kg)					
	1	2	3	4	5	6
200 - 284	2 x Kraby		3 x Kraby		4 x Kraby	

**Number of stays chart - L 244 mm**

Rev. 02

h	Door weight (Kg)												
	1	2	3	4	5	6	7	8	9	10	11	12	13
280 - 324	2 x Kraby						3 x Kraby				4 x Kraby		
325 - 424	2 x Kraby						3 x Kraby				4 x Kraby		
425 - 500	2 x Kraby						3 x Kraby				4 x Kraby		

**Number of stays chart - L 355 mm**

Rev. 02

h	Door weight (Kg)												
	1	2	3	4	5	6	7	8	9	10	11	12	13
380 - 500	2 x Kraby										3 x Kraby		
501 - 600	2 x Kraby										3 x Kraby		

These are experimental results to be checked by the customer. In accordance with the actual European regulation, we suggest to use at least two stays for each door. Our technical department is at your disposal to test further cases out of this chart.



## DROP DOWN DRILLING PLANS WITH KIMANA HINGE

KRABY CONFIGURATOR:



### L 164 mm

Magnet K Lock visible or invisible

K Push Tech 20 mm  
- With magnet  
- Visible or invisible

For details refer to section "PUSH CATCHES & MAGNETIC CATCHES".

Overcrossing 90° door opening angle, it negatively effects the Kimana hinges. 90° max

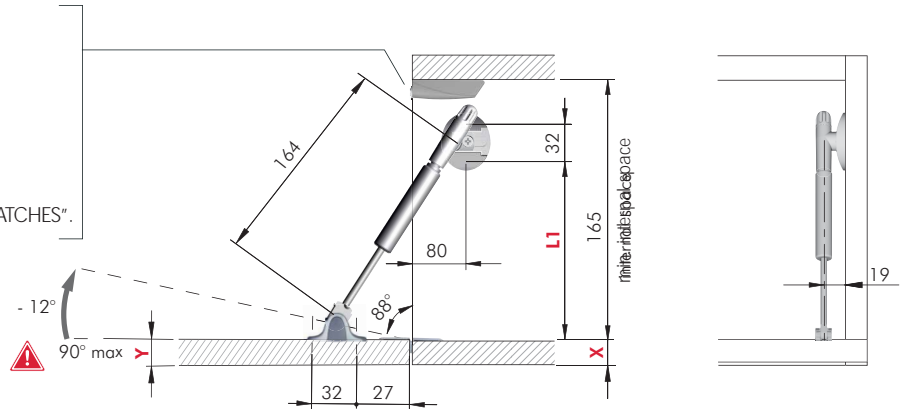

Cabinet (X)		Door (Y)		L1
16 mm	4 mm	16 mm	2 mm	117
16 mm	4 mm	19 mm	-	119
18 mm	2 mm	18 mm	-	117
19 mm	-	16 mm	2 mm	113
19 mm	-	19 mm	-	115
20 mm	-	20 mm	-	115

For Kimana and adapter details refer to section "HINGES".

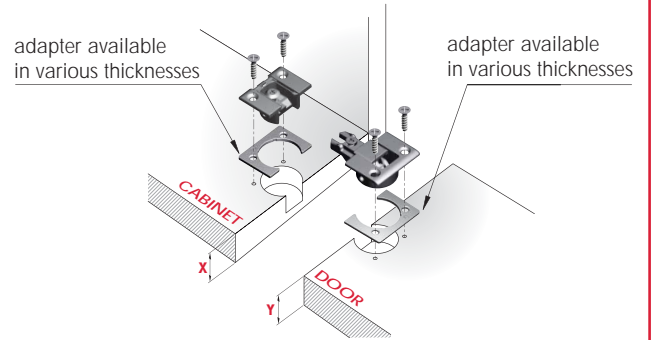

### L 244 mm

Magnet K Lock visible or invisible

K Push Tech 20 mm  
- With magnet  
- Visible or invisible

For details refer to section "PUSH CATCHES & MAGNETIC CATCHES".

Overcrossing 90° door opening angle, it negatively effects the Kimana hinges. 90° max

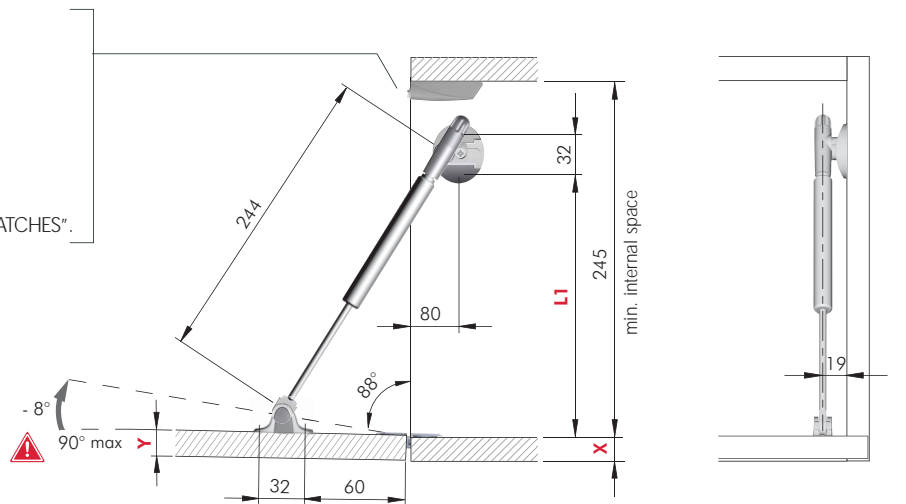

Cabinet (X)		Door (Y)		L1
16 mm	4 mm	16 mm	2 mm	197
16 mm	4 mm	19 mm	-	199
18 mm	2 mm	18 mm	-	197
19 mm	-	16 mm	2 mm	193
19 mm	-	19 mm	-	195
20 mm	-	20 mm	-	195

For Kimana and adapter details refer to section "HINGES".

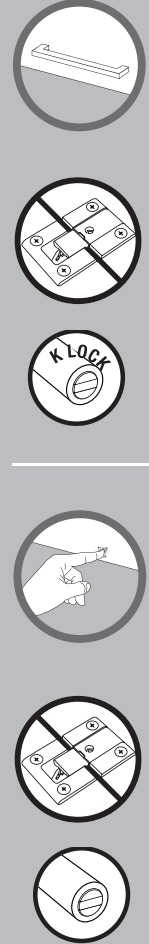
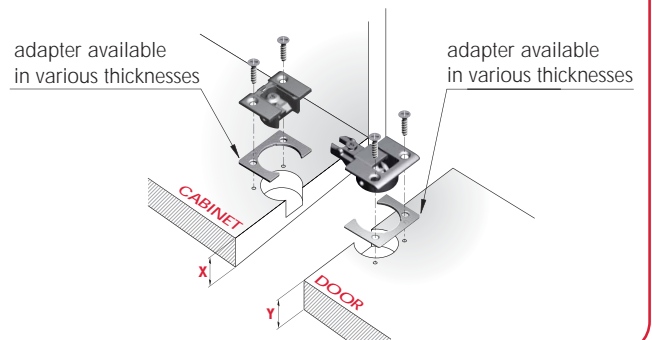







**L 355 mm**

 Magnet K Lock  
visible or invisible

 K Push Tech 20 mm  
- With magnet  
- Visible or invisible

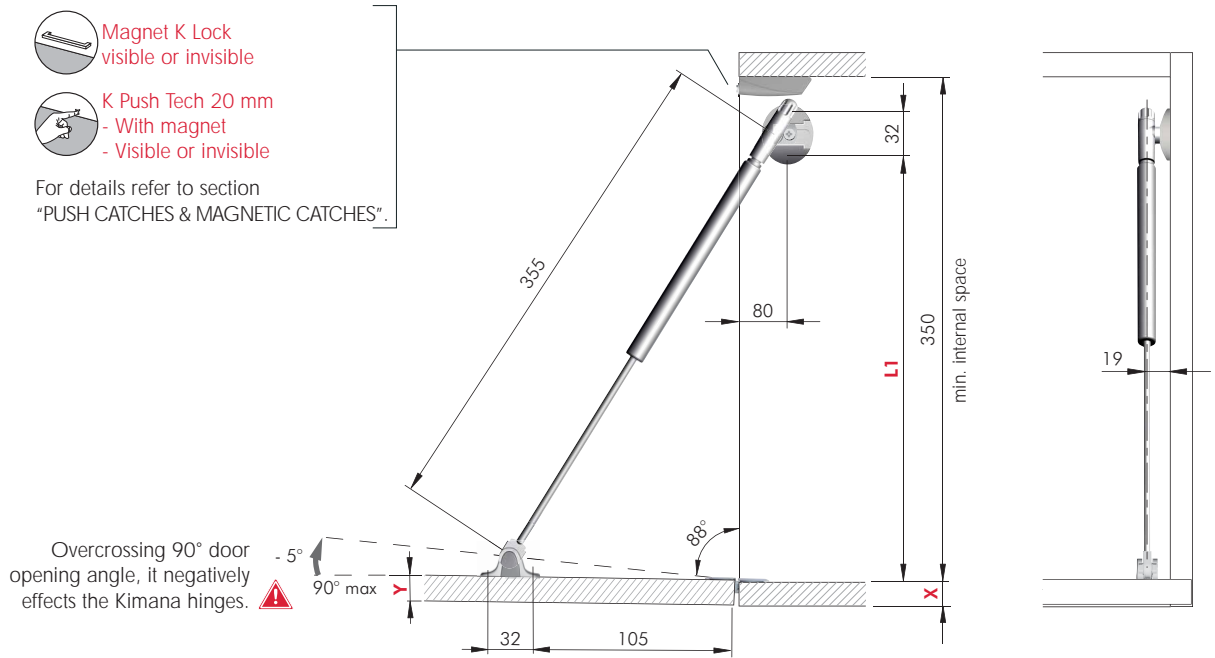
For details refer to section  
"PUSH CATCHES & MAGNETIC CATCHES".



Cabinet (X)		Door (Y)		L1
16 mm	4 mm	16 mm	2 mm	302
16 mm	4 mm	19 mm	-	304
18 mm	2 mm	18 mm	-	302
19 mm	-	16 mm	2 mm	298
19 mm	-	19 mm	-	300
20 mm	-	20 mm	-	300

adapter available  
in various thicknesses

adapter available  
in various thicknesses

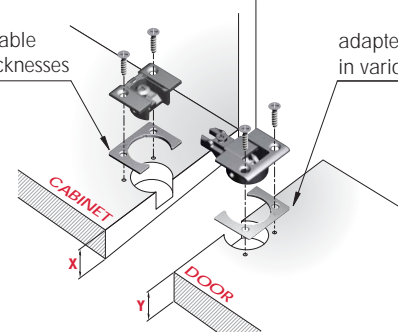

For Kimana and adapter details refer to section "HINGES".

## DROP DOWN DRILLING PLANS WITH STANDARD HINGES OPENING WITH HANDLE

KRABY CONFIGURATOR:

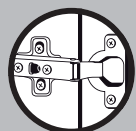
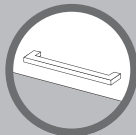

L 164 mm

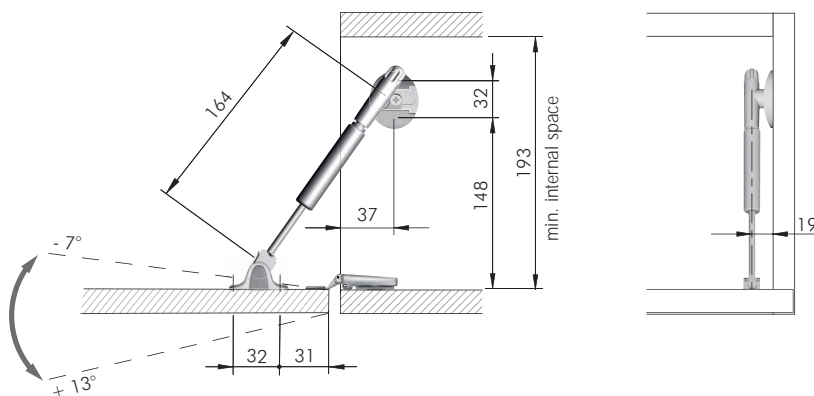

L 244 mm

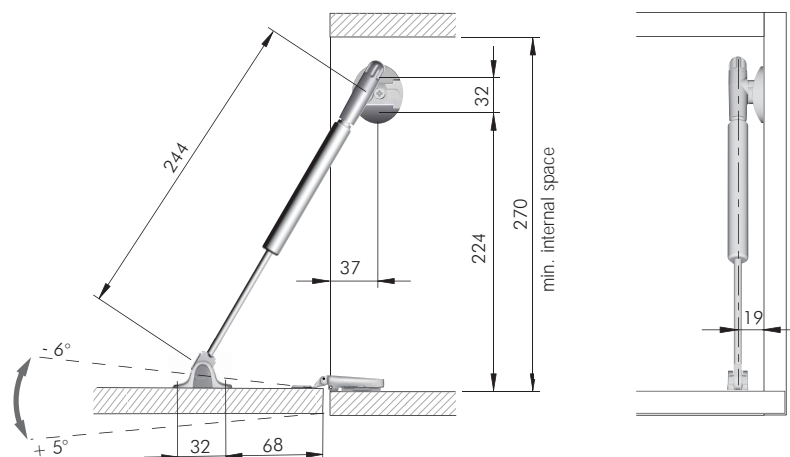

L 355 mm

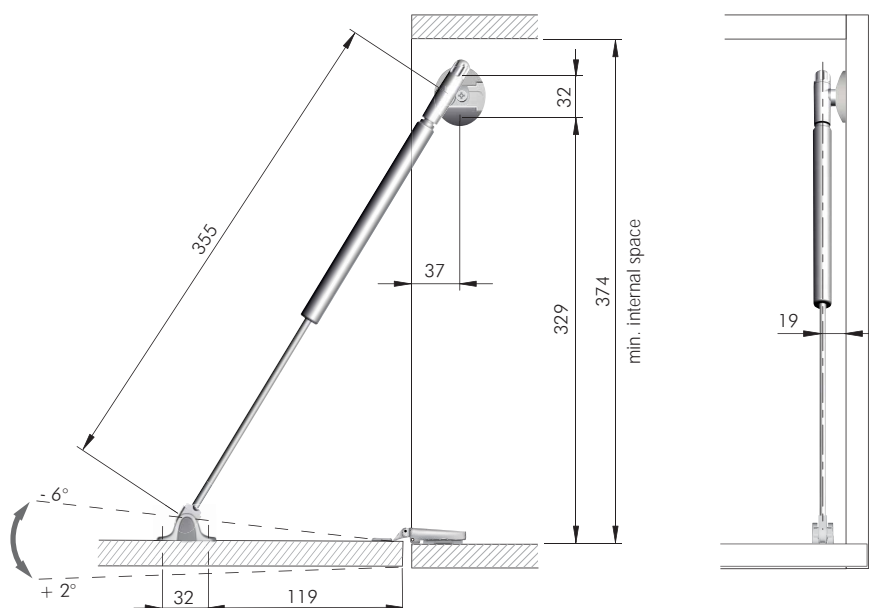

The dimensions of the drilling plans refer to carcasses which use **standard sprung hinges** and mounting plates 0 mm. Please note that the opening angle shown data is purely indicative. It varies with respect to the hinge brand and adjustment carried out.

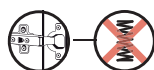

Please note that in case of use of **unsprung hinges**, **magnet K Lock** is required. For details refer to section "PUSH CATCHES & MAGNETIC CATCHES".



## DROP DOWN DRILLING PLANS WITH STANDARD HINGES PUSH TO OPEN

KRABY CONFIGURATOR:

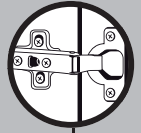

L 164 mm

**K Push Tech 14 mm**  
- With magnet  
- Visible or invisible

For details refer to section "PUSH CATCHES & MAGNETIC CATCHES".

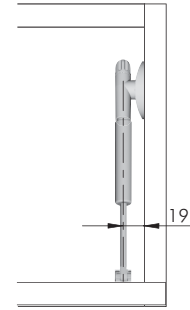
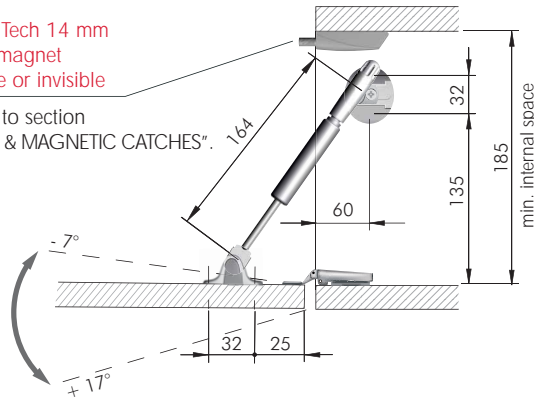

L 244 mm

**K Push Tech 14 mm**  
- With magnet  
- Visible or invisible

For details refer to section "PUSH CATCHES & MAGNETIC CATCHES".

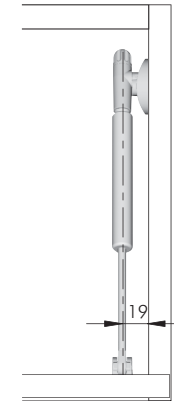
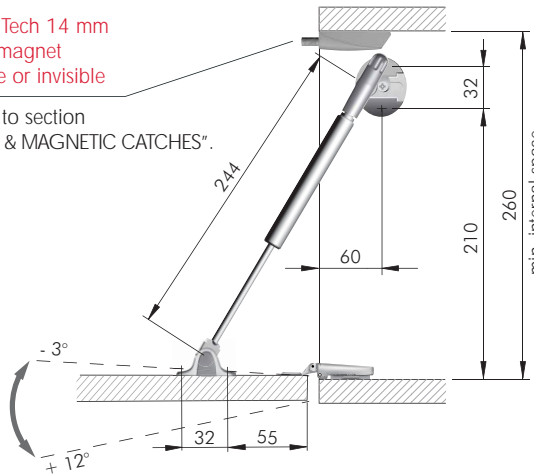

L 355 mm

**K Push Tech 14 mm**  
- With magnet  
- Visible or invisible

For details refer to section "PUSH CATCHES & MAGNETIC CATCHES".

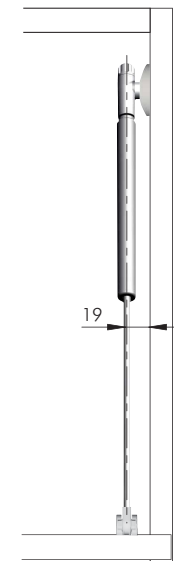
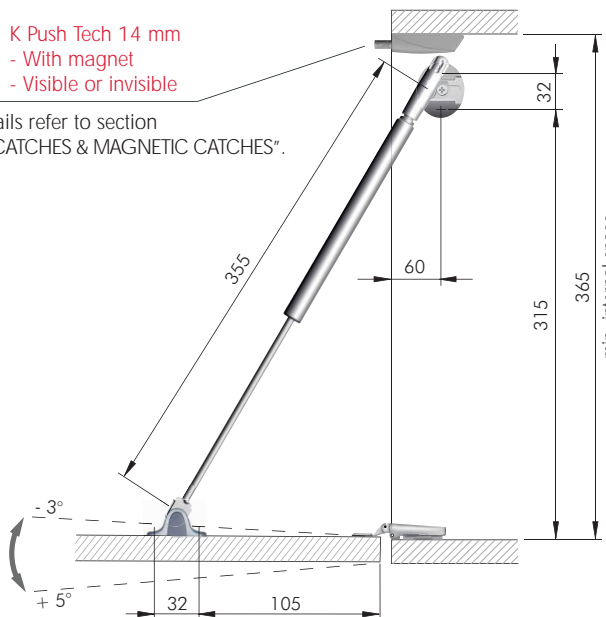

The dimensions of the drilling plan refer to carcasses which use **standard unsprung hinges** and mounting plates 0 mm. Please note that min and max opening angle shown data is purely indicative. It varies with respect to the hinge brand and adjustment carried out.

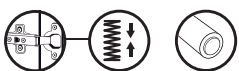

Please note that utilization with **standard sprung hinges** and **K Push Tech with buffer** is also possible. In such case, after the door is initially released by K Push Tech, a manual opening approx. 7cm is required (in order to win the spring resistance). Consequently, the door will automatically open to the fullest. For details refer to section "PUSH CATCHES & MAGNETIC CATCHES".

KRABY CONFIGURATOR:



## DROP DOWN DRILLING PLANS WITH FLAP HINGE

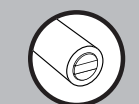
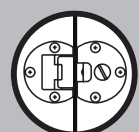
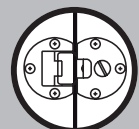
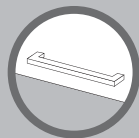

### L 164 mm



Magnet K Lock  
visible or invisible



K Push Tech 20 mm  
- With magnet  
- Visible or invisible

For details refer to section  
"PUSH CATCHES & MAGNETIC CATCHES".

Overcrossing 90° door opening angle, it negatively effects the flap hinges. ⚠️

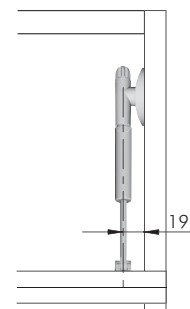
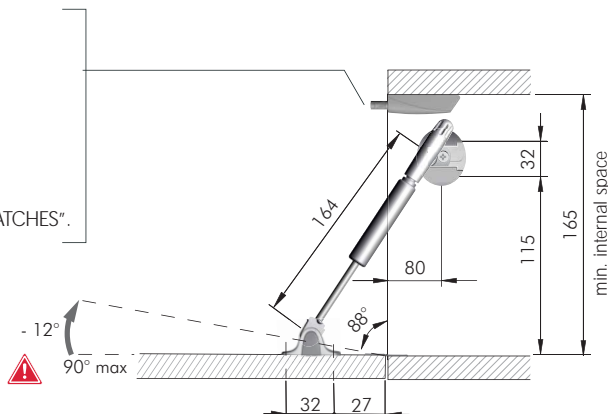

### L 244 mm



Magnet K Lock  
visible or invisible



K Push Tech 20 mm  
- With magnet  
- Visible or invisible

For details refer to section  
"PUSH CATCHES & MAGNETIC CATCHES".

Overcrossing 90° door opening angle, it negatively effects the flap hinges. ⚠️

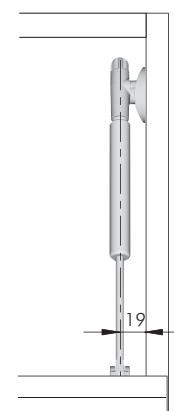
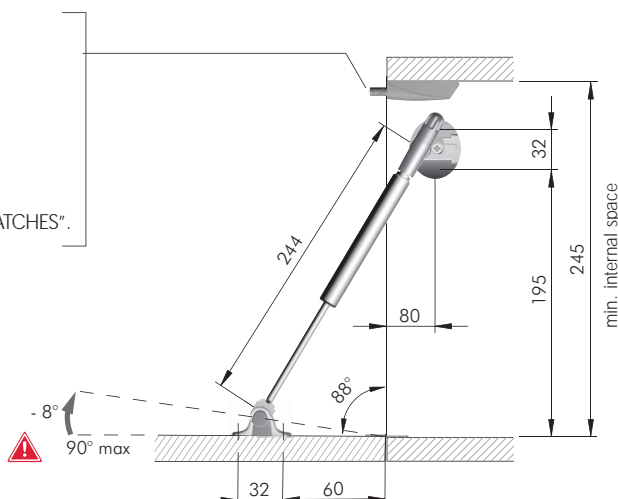

### L 355 mm



Magnet K Lock  
visible or invisible



K Push Tech 20 mm  
- With magnet  
- Visible or invisible

For details refer to section  
"PUSH CATCHES & MAGNETIC CATCHES".

Overcrossing 90° door opening angle, it negatively effects the flap hinges. ⚠️

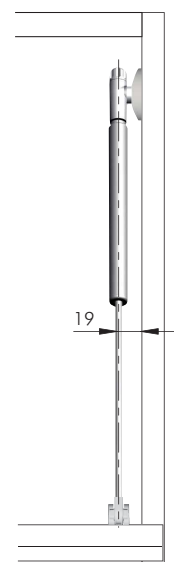
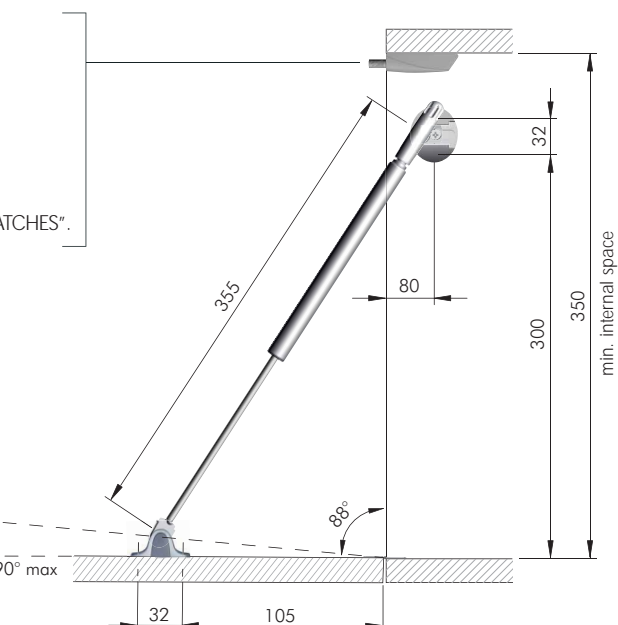



## KRABY BRACKETS

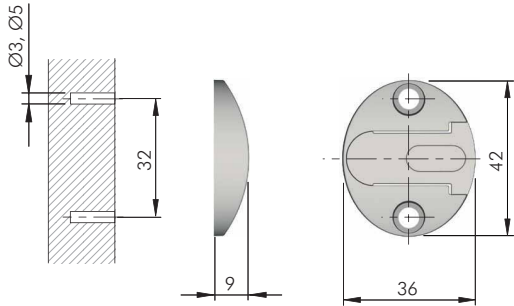

=  $\varnothing 3, \varnothing 5$  mm

ZA

= 100 pcs.



**42901030YC**

recommended fixing countersunk  
head wood screw  $\varnothing 3,5 \times 16$  mm

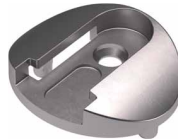
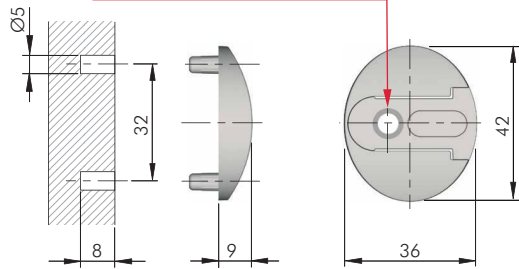

=  $\varnothing 5$  mm

ZA

= 100 pcs.



**42901010YC**

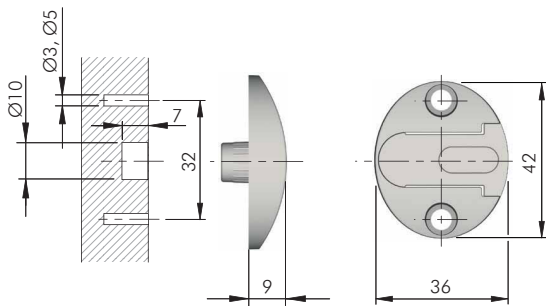

=  $\varnothing 3, \varnothing 5$  mm +  $\varnothing 10$  mm

ZA

= 100 pcs.



**42901020YC**

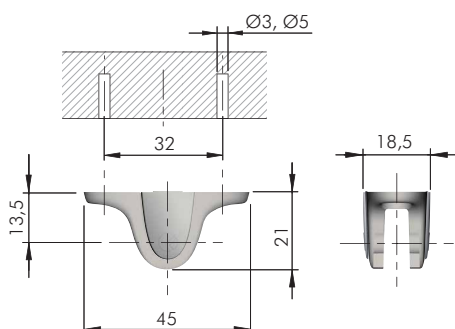

=  $\varnothing 3, \varnothing 5$  mm

ZA

= 100 pcs.



**4291802000**

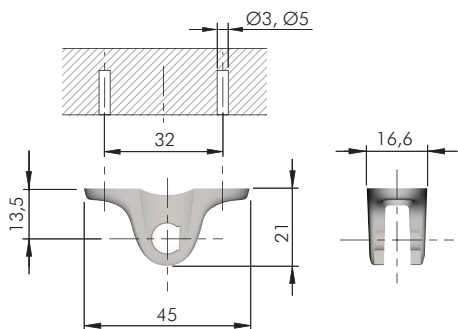

= Ø 3, Ø 5 mm

ZA



= 100 pcs.



42918010YC

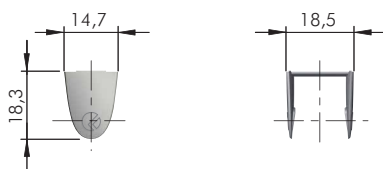

EPg



= 100 pcs.



4291901000

## KRABY FIXING ACCESSORIES

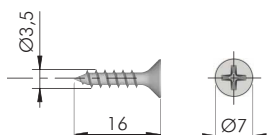

= Ø 2,5 mm



= PZ2

ST



= 10.000 pcs.



60101390YA

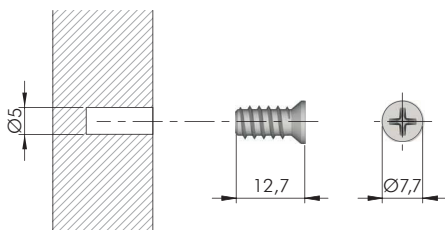

= Ø 5 mm



= PZ2

ST



= 5000 pcs.



60501050YA



## KRABY ADAPTERS FOR ALUMINIUM FRAME DOOR

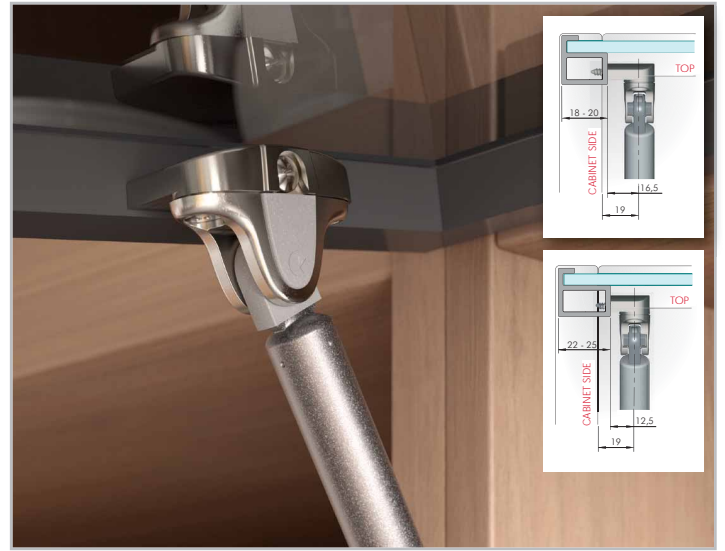
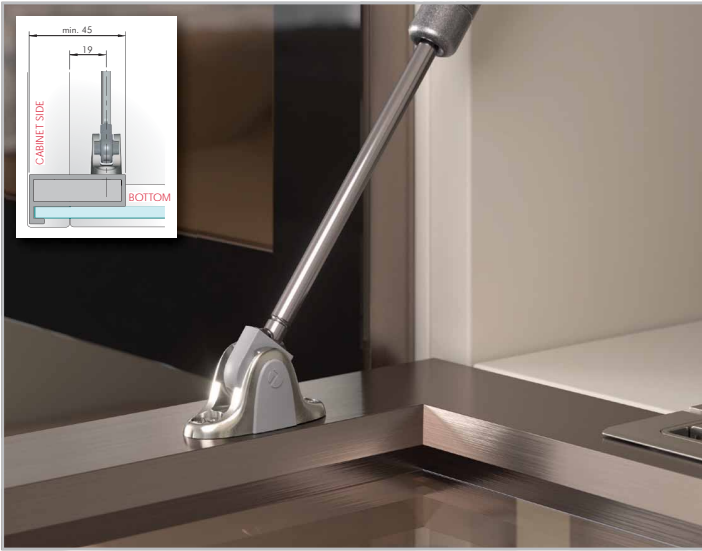

INSTALLATION ON WIDER ALUMINIUM FRAME DOOR

INSTALLATION ON NARROW ALUMINIUM FRAME DOOR

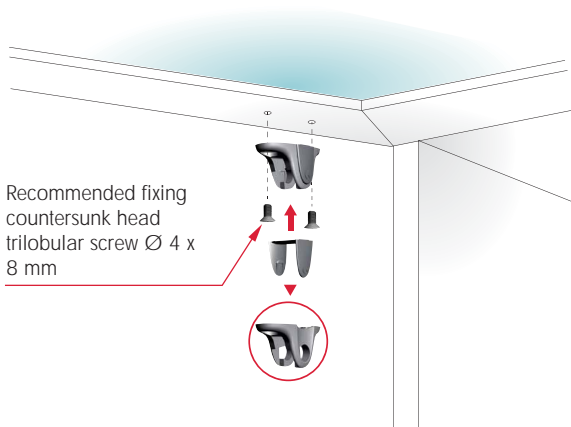

**VERY IMPORTANT**  
The door bracket has to be placed in vertical position with the slot facing forwards.

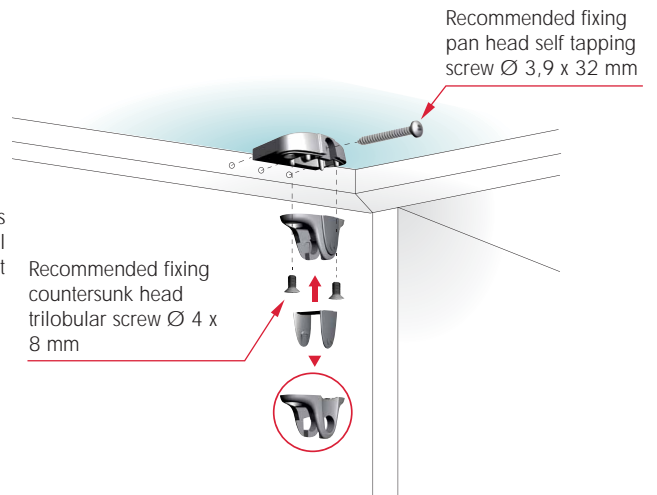

### WIDER ALUMINIUM FRAME DOOR

Condition A

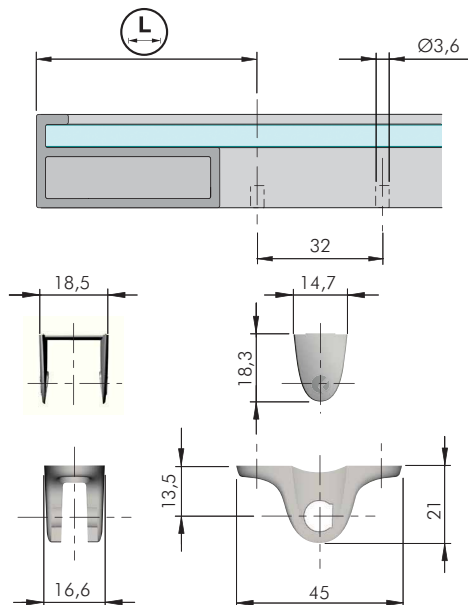
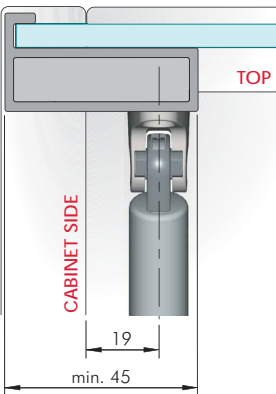

= Ø 3,6 mm

ZA EP

= 100 pcs.



42918010YC



4291901000





Assembling

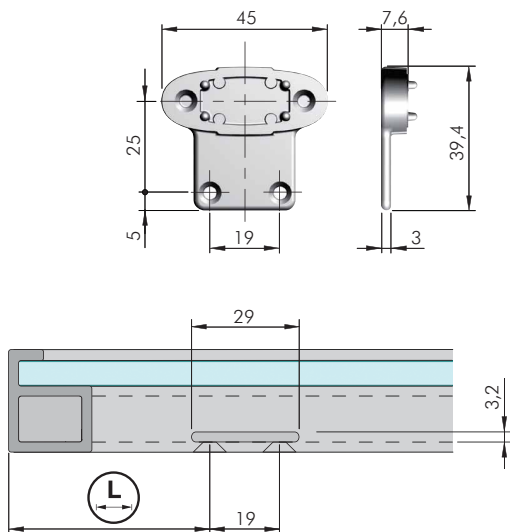
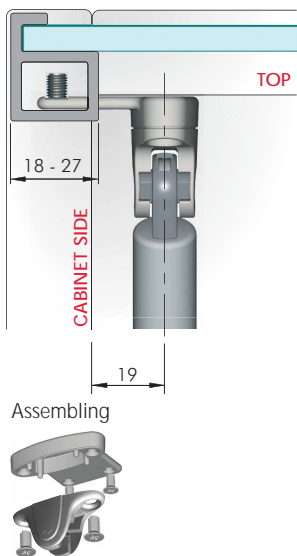

## NARROW ALUMINIUM FRAME DOOR

### Condition B



ZA  = 100 pcs.



42903010YC



42918010YC





4291901000

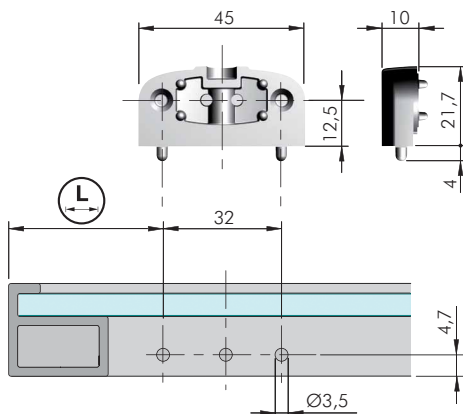
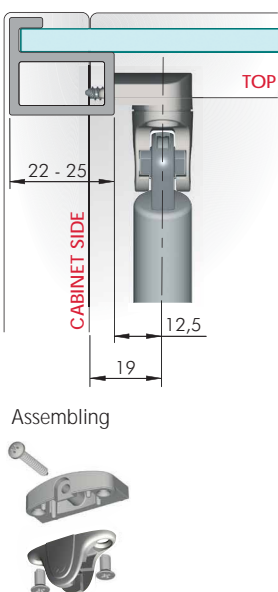

### Condition C



 = Ø 3,5 mm

ZA  = 100 pcs.



42904010YC



42918010YC



4291901000



### Condition D

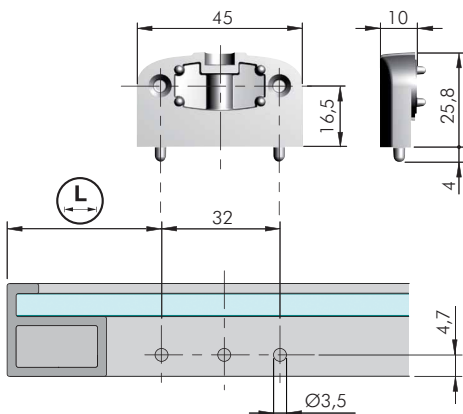
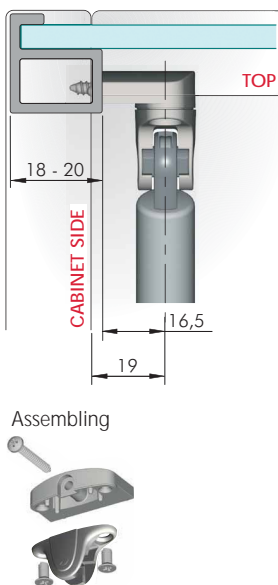

 = Ø 3,5 mm

ZA  = 100 pcs.



42905010YC



42918010YC



4291901000





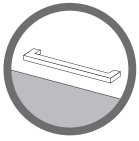

KRABY	L	
164	31	37,5
244	68	74,5
355	119	125,5



KRABY	L	
164	25	31,5
244	55	61,5
355	105	111,5

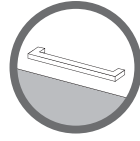

KRABY	L	
164	27	33,5
244	60	66,5
355	105	111,5

For details refer to related sections.

## ALUMINIUM ADAPTERS FIXING ACCESSORIES

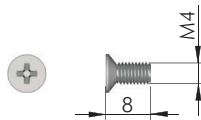

= PZ2

ST

= on request



42906010YA

For wider aluminium frame and for condition A, B, C, D.

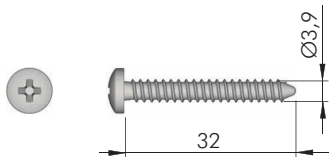

= PZ2

ST

= on request



60203410YA

For condition C and D.

## KRABY FOR WRITING DESK



### INSTALLATION

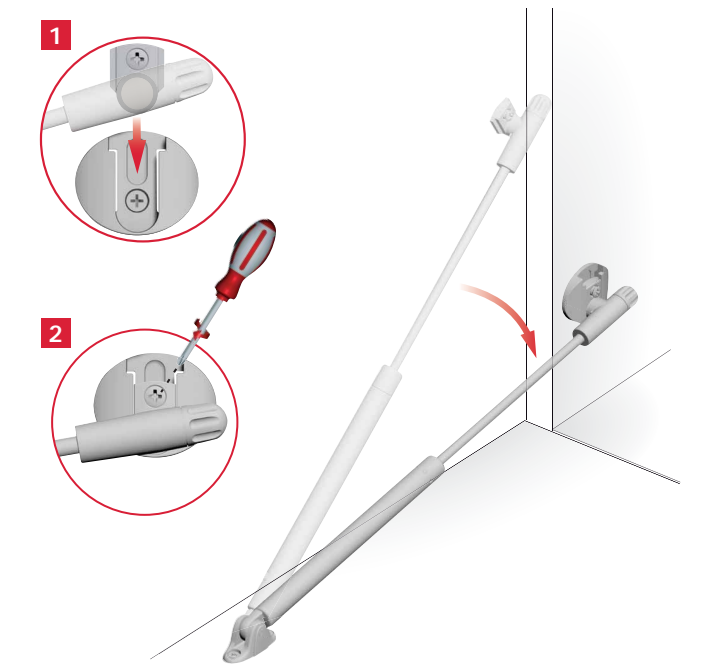
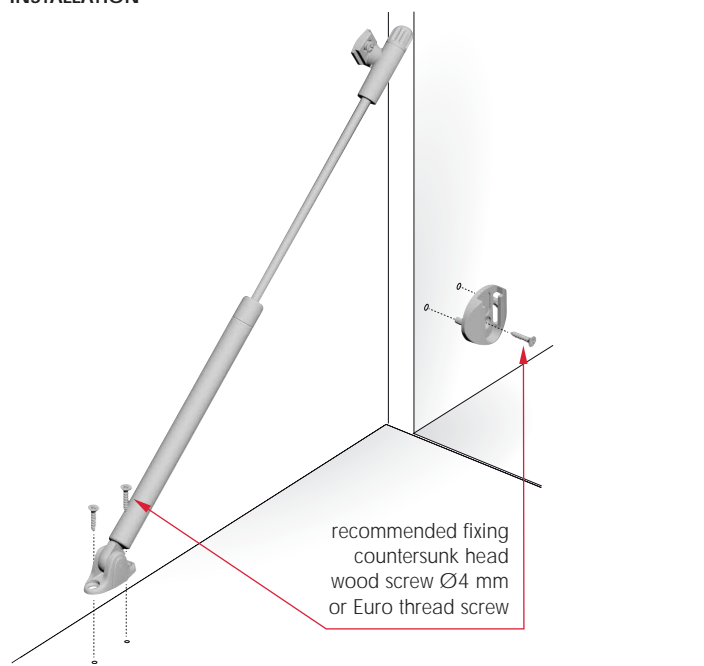

### ADJUSTMENTS

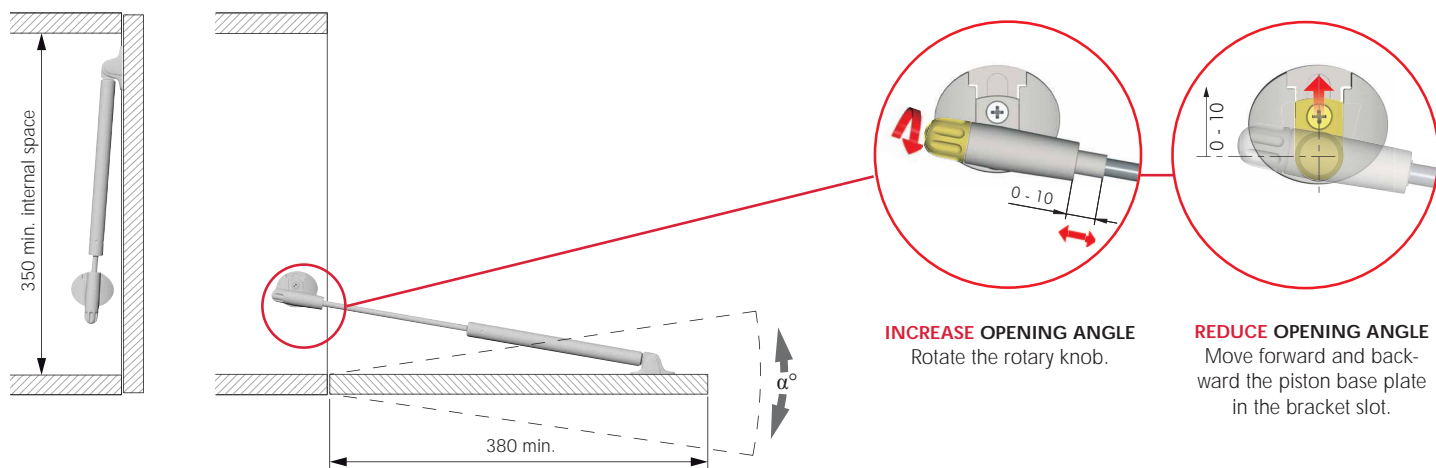



## DRILLING PLAN WITH KIMANA HINGE

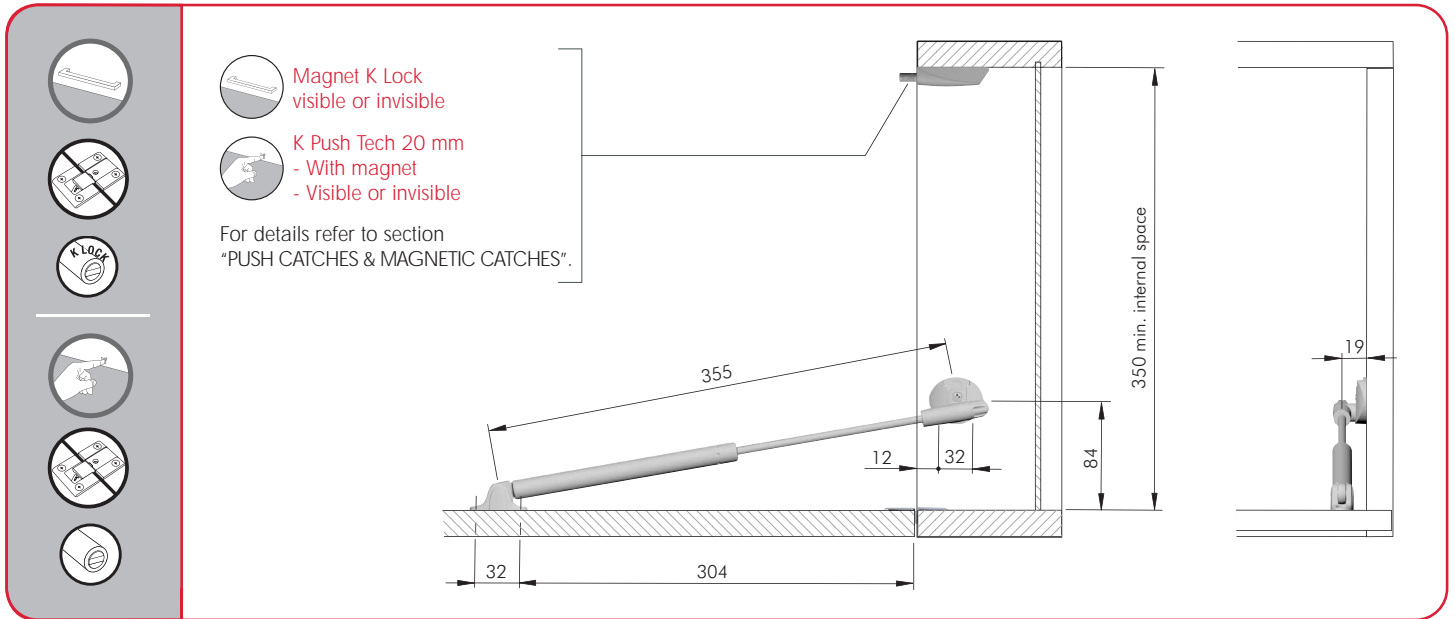

## Number of stays chart

Rev. 00

h	Door weight (Kg)												
	1	2	3	4	5	6	7	8	9	10	11	12	
380 - 450										2 x Kraby			
451 - 550										2 x Kraby			

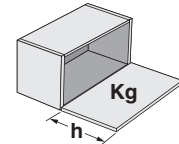

These are experimental results to be checked by the customer. Our technical department is at your disposal to test further cases out of this chart. In accordance with the actual European regulation, it is necessary to use two lid stays for each door.

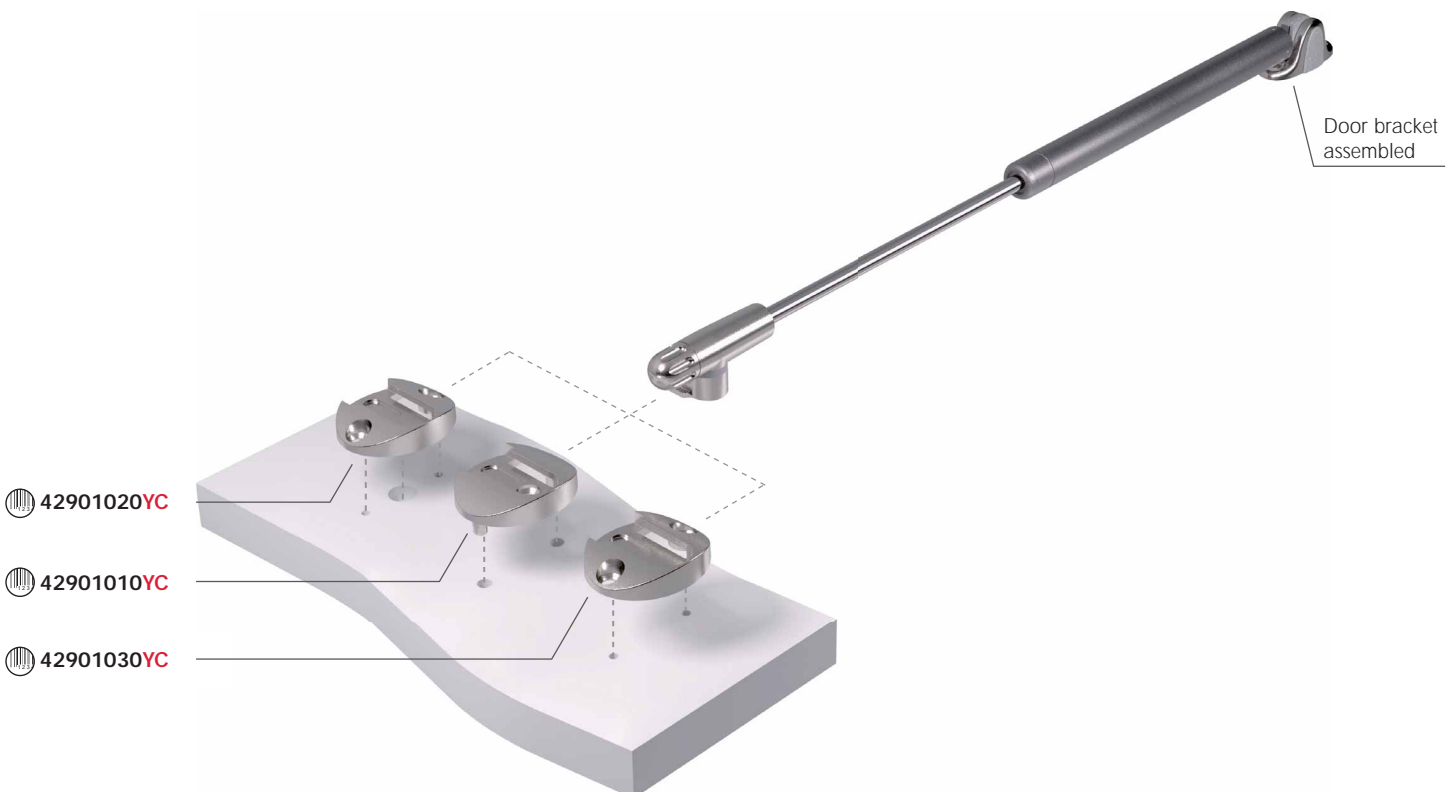

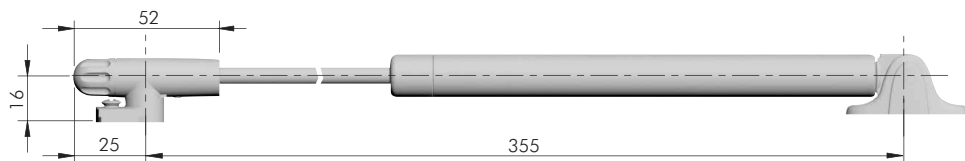

ZAnk

EP

ST

= 50 pcs.



42250030UZ

## SIDE BRACKETS

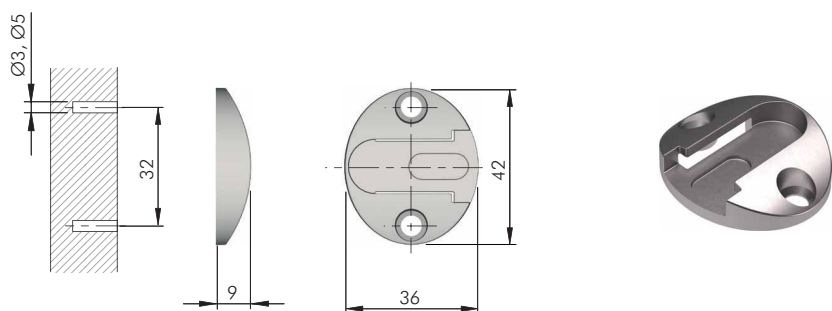

= Ø 3, Ø 5 mm

ZA

= 100 pcs.



42901030YC

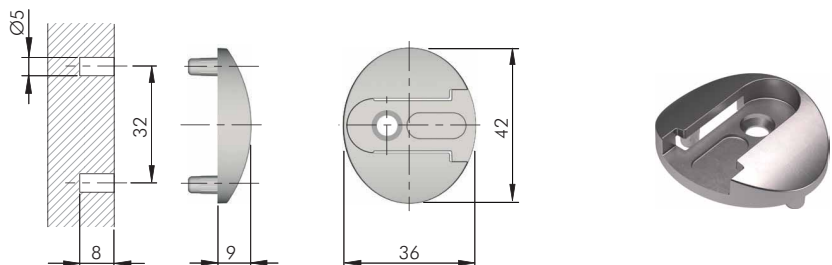

= Ø 5 mm

ZA

= 100 pcs.



42901010YC

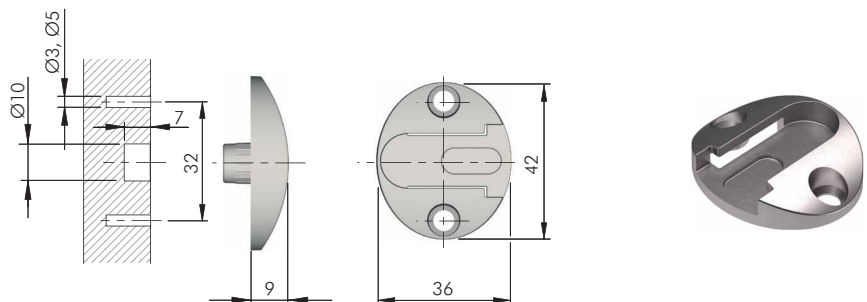

= Ø 3, Ø 5 mm + Ø 10 mm

ZA

= 100 pcs.



42901020YC



## FIXING ACCESSORIES

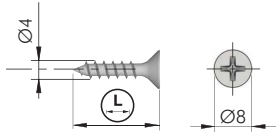

= Ø 2,5 mm +   
 = PZ2  
 = 10.000 pcs.

<b>60101570YA</b>		16
<b>60101580YA</b>		18

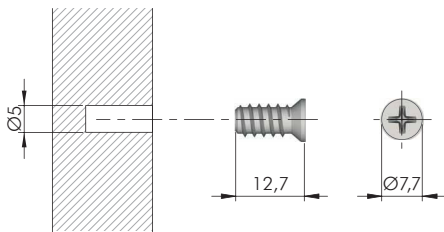

= Ø 5 mm +   
 = PZ2  
 = 5000 pcs.

<b>60501050YA</b>	

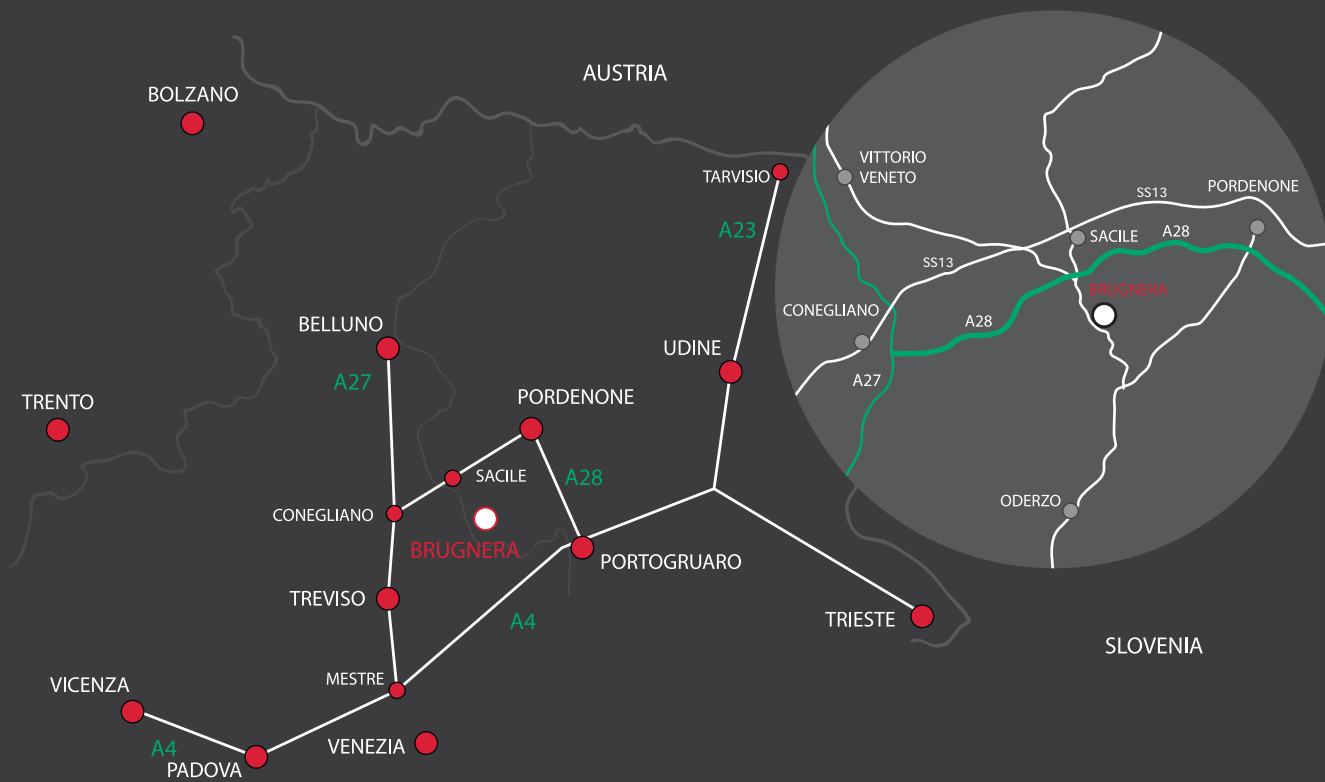

[www.italianaferramenta.it](http://www.italianaferramenta.it)